



www.wnsoilfield.com
405-677-7222

Table of Contents

WNS Lowery-Wellheads	5
Type L-K Tubing Head	6
Type L-R Tubing Head	8
Type L-92 Casing Head	10
Type L-HFC-W Tubing Head.....	12
Type L-HB Tubing Head	14
Type L-A7 Tubing Head	16
Type L-SO Tubing Head.....	18
Type L-HHS Tubing Head	20
Type L-CE Casing Head	22
Type L-ECA Casing Head	24
Type L-MC Casing Head	26
Type L-CJ Casing Head	28
Type L-MS Tubing Head	30
Type L-SW Tubing Head	32
Type L-S Tubing Head	34
Type L-HW Tubing Head	36
Type L-MSR Casing Head	38
WNS Lowery-Wellhead Accessories and Flanges	40
Slip Joint Belled Nipples.....	41
Fittings.....	42
Casing Supports.....	43
Flanges	44
Threaded Flanges.....	47
Seating Nipples	48

Table of Contents (Continued)

WNS Lowery-Rod Accessories	49
Pumping Tees	50
Rod Lubricator.....	51
Rod Rotator	52
Polished Rod Clamps	53
Stuffing Boxes.....	54
Cone Packing	57
Blow Out Preventors	58
WNS Lowery-Valves	59
Series 20 Choke	60
Swing Check Valves.....	61
Import Swing Check Valve.....	64
Ball Check Valves	65
Import Ball Check Valve	66
Back Pressure Regulator.....	67
Balanced Back Pressure Regulator	68
ZPEX Coating.....	69
General Information	70

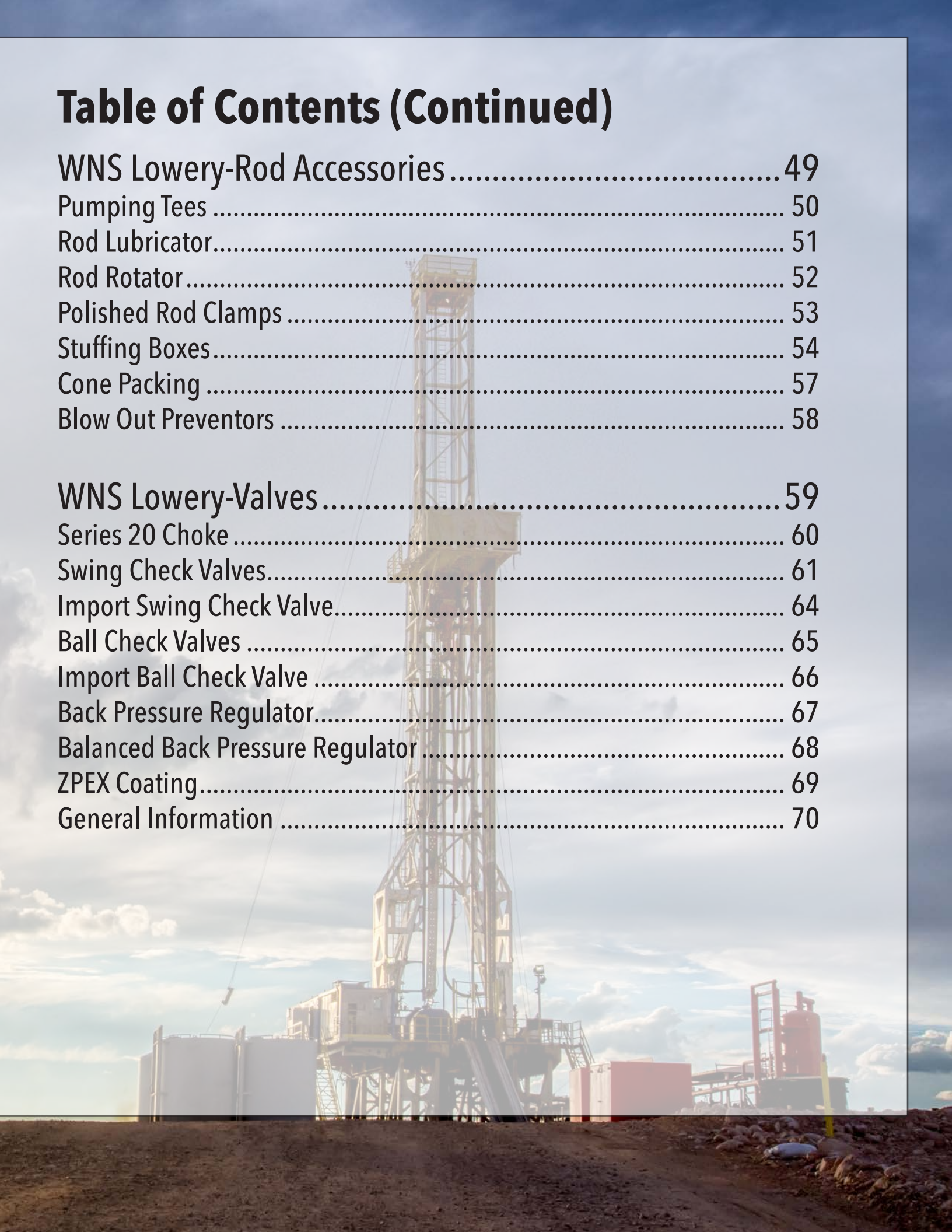

Lowery Wellheads

Lowery Wellheads was established in 1979 in Tulsa, Oklahoma by the Lowery family. Over the past 40 years the company grew to be a significant regional supplier of tubing heads, casing heads, stuffing boxes, tees, flanges, and associated products for the oil & gas industry. Lowery is known for its high-quality products, made primarily with American materials and labor, using precision in-house CNC machining centers. Lowery Wellheads are ISO 9001 8:3 registered and our quality system meets API Q1 certifications.

Whittle Neher Systems

Whittle & Neher Systems, founded in 1984 in Oklahoma City, OK, is a leading manufacturer of high quality stainless steel, carbon steel, and ductile iron check valves for oilfield, industrial, and special applications. We also manufacture a full line of high quality stuffing boxes, pumping and flowing tees, and cone type packing for the oil industry. Our company is committed to producing excellent products that meet the needs and expectations of our customers at a cost that represents value.

WNS Lowery

In 2018, Whittle & Neher Systems acquired Lowery Well Heads, Inc. to dramatically expand its oilfield product lines and market reach. Whittle & Neher was best known for its diverse check valve product line for oilfield, industrial, and special applications. The synergistic combinations of Whittle & Neher and Lowery Wellheads created WNS Lowery. WNS Lowery offers a broad single-source product line with quality and value pricing.

WNS Lowery is part of the Marsh Bellofram Group of Companies. Marsh Bellofram is a diversified industrial manufacturer with operations in the United States, United Kingdom, China, and India. Marsh Bellofram provides WNS Lowery with management expertise, growth capital, engineering & manufacturing support, sourcing services, and administrative functions.



Wellheads

Wellhead Color Code

- Green Larkin
- Red Huber
- Blue Hinderlighter

100% Interchangeable

TYPE L-K TUBING HEAD

1,500 PSI Working Pressure

L-SK TUBING HEAD WITH STRIPPER RUBBER

- 1,500 PSI working pressure
- Adapter with O-Ring: 25.4 Lbs
- Stripper Rubber available for all sizes
- Stripper Rubbers are not designed to withstand full pressure rating.

FEATURES:

- Seamless steel Body
- Full opening bore on all sizes
- Hinged Slips with Snap Ring
- Stripper Rubber available
- Male or Female bottom connections available



HEAD COMPLETE			
Bottom Connection (Inches)	4 ½ 8RD	5 ½ 8RD	7 8RD
Bore	Full	Full	Full
Suspended String (Inches)	2 ¾, 2 ¾	2 ¾, 2 ¾	2 ¾, 2 ¾
Max Slip Load Rating (lbs)	65,000	65,000	65,000
Cap Thread (Inches)	7 ¾ 8RD API MOD	7 ¾ 8RD API MOD	7 ¾ 8RD API MOD
Cap Material	Ductile Iron	Ductile Iron	Ductile Iron
Body Material	Carbon Steel	Carbon Steel	Carbon Steel
Height (Inches)	12	12	12
Weight (lbs)	86	85	92
Packing Rubber OD	6.845	6.845	6.845



TOP CAP [A]

L-K Tubing Head	Part Number	QTY
	30710	1



TOP PLATE [B]

L-K Tubing Head	Part Number	QTY
2 3/8"	30715	1
2 7/8"	30716	1



PACKING RUBBER [C]

L-K Tubing Head	Part Number	QTY
Packing Rubber 6.845 OD		
2 3/8"	30722	1
2 7/8"	30723	1



BOTTOM PLATE [D]

L-K Tubing Head	Part Number	QTY
Bottom Plate		
2 3/8"	30729	1
2 7/8"	30730	1



SLIP ASSEMBLY AND SNAP RING [E]

L-K Tubing Head	Part Number	QTY
Slip		
2 3/8"	30153410	1
2 7/8"	30153411	1



SLIP BOWL [F]

L-K Tubing Head	Part Number	QTY
Slip Bowl	30733	1



ADAPTER [G]

L-K Tubing Head	Part Number	QTY
Stripper Rubber Adapter with O-Ring	30154502	1
O-Ring	30744	1



STRIPPER RUBBER [H]

L-K Tubing Head	Part Number	QTY
1 1/2"	30747	1
2 1/8"	30747	1
2 3/8"	30748	1
2 7/8"	30749	1



BODY [I]

L-K Tubing Head	Part Number	QTY
Body		
4 1/2" 8RD Male	30150007	1
4 1/2" 8RD Female	30150262	1
5 1/2" 8RD Male	30150008	1
5 1/2" 8RD Female	30150263	1
7" 8RD Male	30150009	1
7" 8RD Female	30150264	1
7" Slip Joint	30150500	1

TYPE L-R TUBING HEAD

2,000 PSI Working Pressure

L-SR TUBING HEAD WITH STRIPPER RUBBER

- 2,000 PSI working pressure
- Adapter with O-Ring: 47 lbs
- Stripper rubbers available for: 1 ½, 2 ¼, 2 ¾, 2 ⅞
- Stripper Rubbers are not designed to withstand full pressure rating

FEATURES:

- Seamless steel Body
- Full opening bore on all sizes
- Hinged Slips with Snap Ring
- Stripper Rubber available
- 8 ⅞ 8RD API Modified top body thread
- 3,000 PSI Model Available
- Male or Female bottom connection available



HEAD COMPLETE			
Bottom Connection	4 ½ 8RD	5 ½ 8RD	7 8RD
Bore	Full	Full	Full
Suspended String (Inches)	1 ½, 2 ¼, 2 ¾, 2 ⅞	1 ½, 2 ¼, 2 ¾, 2 ⅞, 3 ½	1 ½, 2 ¼, 2 ¾, 2 ⅞, 3 ½
Max Slip Load Rating (lbs)	85,000	85,000	85,000
Cap Thread (Inches)	8 ⅞ 8RD API MOD	8 ⅞ 8RD API MOD	8 ⅞ 8RD API MOD
Cap Material	Ductile Iron	Ductile Iron	Ductile Iron
Body Material	Carbon Steel	Carbon Steel	Carbon Steel
Height (Inches)	13	13	13
Weight (lbs)	151	148	150
Packing Rubber OD	7 ¼	7 ¼	7 ¼

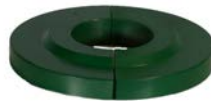

TOP CAP [A]	Part Number	QTY
L-R Tubing Head	30760	1

TOP PLATE [B]		
L-R Tubing Head	Part Number	QTY
1 ½"	30763	1
2 ¼"	30764	1
2 ¾"	30765	1
2 ⅞"	30766	1
3 ½"	301915	1
2 ¾" (3000 psi L-R-3)	301070	1
2 ⅞" (3000 psi L-R-3)	301299	1
3 ½" (3000 psi L-R-3)	301985	1

PACKING RUBBER [C]		
L-R Tubing Head	Part Number	QTY
1 ½"	30771	1
2 ¼"	30152822	2
2 ¾"	30773	1
2 ⅞"	30774	1
3 ½"	30152829	2





BOTTOM PLATE [D]

L-R Tubing Head	Part Number	QTY
1 1/2"	30779	1
2 1/8"	30780	1
2 3/8"	30781	1
2 7/8"	30782	1
3 1/2"	301916	1



SLIP ASSEMBLY AND SNAP RING [E]

L-R Tubing Head	Part Number	QTY
4 1/2" 8RD		
1 1/2"	30153443	1
2 1/8"	30153444	1
2 3/8"	30153445	1
2 7/8"	30153446	1
5 1/2" 8RD		
1 1/2"	30153443	1
2 1/8"	30153444	1
2 3/8"	30153445	1
2 7/8"	30153446	1
3 1/2"	30153447	1
7" 8RD		
1 1/2"	30153443	1
2 1/8"	30153444	1
2 3/8"	30153445	1
2 7/8"	30153446	1
3 1/2"	30153447	1



SLIP BOWL [F]

L-R Tubing Head	Part Number	QTY
	30786	1



ADAPTER [G]

L-R Tubing Head	Part Number	QTY
Stripper Rubber Adapter with O-Ring	30154509	1
O Ring	3052	1



STRIPPER RUBBER [H]

L-R Tubing Head	Part Number	QTY
4 1/2" 8RD		
1 1/2"	30803	1
2 1/8"	30803	1
2 3/8"	30804	1
2 7/8"	30805	1
5 1/2" 8RD		
1 1/2"	30803	1
2 1/8"	30803	1
2 3/8"	30804	1
2 7/8"	30805	1
7" 8 RD		
1 1/2"	30803	1
2 1/8"	30803	1
2 3/8"	30804	1
2 7/8"	30805	1



BODY [I]

L-R Tubing Head	Part Number	QTY
4 1/2" 8RD Male	30150039	1
4 1/2" 8RD Female	30150276	1
5 1/2" 8RD Male	30150040	1
5 1/2" 8RD Female	30150277	1
7" 8 RD Male	30150041	1
7" 8 RD Female	30150280	1

TYPE L-92 CASING HEAD

2,000 PSI Working Pressure

FEATURES:

- Full opening bore on all sizes
- 10 3/4 8RD API Modified top thread on 8 5/8 body
- 11 3/4 8RD API Modified top thread on 9 5/8 body
- 16 8RD API Modified top thread on 13 3/8 body
- Heavy Duty hinged Slip segments with locking hinge link.
- Male, Female, or Slip Joint bottom connection available



HEAD COMPLETE			
Bottom Connection (Inches)	8 3/4 8RD	9 3/4 8RD	13 3/4 8RD
Bore	Full	Full	Full
Suspended String (Inches)	4 1/2, 5 1/2	4 1/2, 5 1/2, 7	8 3/4, 9 3/4, 10 1/4
Max Slip Load Rating (lbs)	120,000	120,000	160,000
Cap Thread (Inches)	10 3/4 8RD MOD	11 3/4 8RD MOD	16 8RD MOD
Cap Material	Ductile Iron	Ductile Iron	Steel
Body Material	Carbon Steel	Carbon Steel	Carbon Steel
Height (Inches)	12 1/2	13	16
Weight (lbs)	180	230	450



TOP CAP [A]		
L-92 Casing Head	PART NUMBER	QTY
L-92 Casing Head 7"	301710	1
L-92 Casing Head 8 3/4"	30990	1
L-92 Casing Head 9 3/4"	301791	1
L-92 Casing Head 13 3/4"	30820	1



TOP PLATE [B]		
L-92 Casing Head	Part Number	QTY
L-92 Casing Head 7"	301711	1
L-92 Casing Head 8 3/4"	30995	1
L-92 Casing Head 9 3/4"	30999	1
L-92 Casing Head 9 3/4"	301792	1
L-92 Casing Head 9 3/4"	301793	1
L-92 Casing Head 9 3/4"	301794	1
L-92 Casing Head 13 3/4"	30821	1
L-92 Casing Head 13 3/4"	30825	1
L-92 Casing Head 13 3/4"	30829	1



PACKING RUBBER [C]		
L-92 Casing Head	Part Number	QTY
Packing Rubber 7 1/2" OD	30152832	2
L-92 Casing Head 8 3/4"	30152814	2
Packing Rubber 9 3/4" OD	301000	1
L-92 Casing Head 9 3/4"	301795	1
Packing Rubber 10 7/8" OD	301796	1
L-92 Casing Head 9 3/4"	301797	1
L-92 Casing Head 13 3/4"	30152816	2
Packing Rubber 14" OD	30152817	2
L-92 Casing Head 13 3/4"	30152820	2



BOTTOM PLATE [D]		
L-92 Casing Head	Part Number	QTY
L-92 Casing Head 7"	30369	1
L-92 Casing Head 8 3/4"	30997	1
L-92 Casing Head 9 3/4"	301001	1
L-92 Casing Head 9 3/4"	301798	1
L-92 Casing Head 9 3/4"	301799	1
L-92 Casing Head 9 3/4"	301800	1
L-92 Casing Head 13 3/4"	30823	1
L-92 Casing Head 13 3/4"	30827	1
L-92 Casing Head 13 3/4"	30831	1



SLIP [E]		
L-92 Casing Head	Part Number	QTY
L-92 Casing Head 7"	30153488	1
L-92 Casing Head 8 3/4"	30153470	1
L-92 Casing Head 9 3/4"	30153471	1
L-92 Casing Head 9 3/4"	30153491	1
L-92 Casing Head 9 3/4"	30153492	1
L-92 Casing Head 9 3/4"	30153493	1
L-92 Casing Head 13 3/4"	30153473	1
L-92 Casing Head 13 3/4"	30153474	1
L-92 Casing Head 13 3/4"	30153475	1



BODY [F]		
L-92 Casing Head	Part Number	QTY
L-92 Casing Head 7"	30150790	1
L-92 Casing Head 8 3/4"	30150772	1
L-92 Casing Head 8 3/4"	30151021	1
L-92 Casing Head 8 3/4"	30151267	1
L-92 Casing Head 9 3/4"	30150793	1
L-92 Casing Head 9 3/4"	30151044	1
L-92 Casing Head 9 3/4"	30151274	1
L-92 Casing Head 13 3/4"	30150773	1
L-92 Casing Head 13 3/4"	30151022	1
L-92 Casing Head 13 3/4"	30151268	1

405-677-7222
 sales@wnsoilfield.com
 www.wnsoilfield.com

TYPE L-HFC-W TUBING HEAD

1,000 PSI Working Pressure

L-HFCS-W TUBING HEAD WITH STRIPPER RUBBER

- 1,000 PSI Working Pressure
- Adapter with O-Ring: 16.4 lbs
- Stripper Rubber: 1 ½, 2 ¼, 2 ¾
- Stripper Rubbers are not designed to withstand full pressure rating

FEATURES:

- Full opening bore on 4 ½ body
- Hinged Slips with Snap Ring
- Large diameter Top Cap with hammer lugs
- Stripper Rubber available
- Male or Female bottom connection available

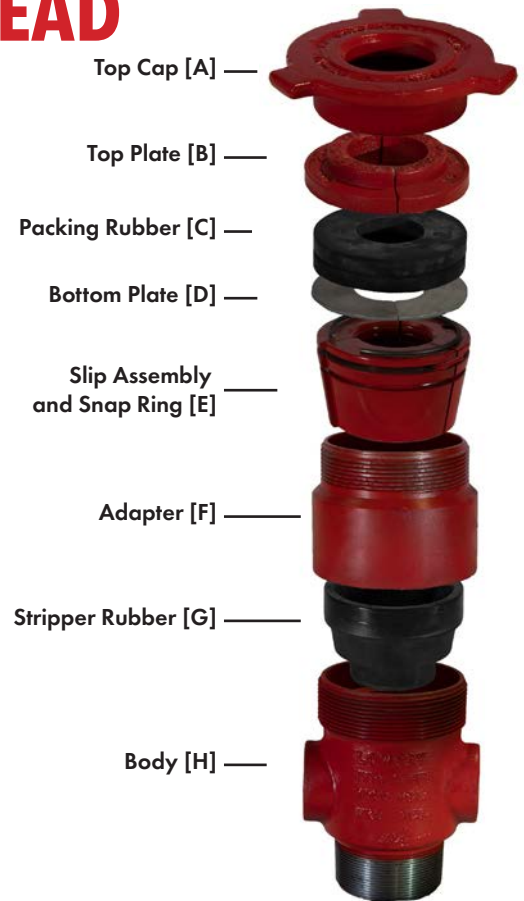

HEAD COMPLETE

Bottom Connection (Inches)	4 ½ 8RD	5 ½ 8RD	7 8RD
Bore (Inches)	Full	4	4
Suspended String (Inches)	1 ½, 2 ¼, 2 ¾, 2 ¾	1 ½, 2 ¼, 2 ¾, 2 ¾	1 ½, 2 ¼, 2 ¾, 2 ¾
Max Slip Load Rating (lbs)	35,000	35,000	35,000
Cap Thread (Inches)	6" 6V	6" 6V	6" 6V
Cap Material	Ductile Iron	Ductile Iron	Ductile Iron
Body Material	Ductile Iron	Ductile Iron	Ductile Iron
Height (Inches)	11	11	13
Weight (lbs)	46	52	57
Packing Rubber OD	5 ¾	5 ¾	5 ¾



TOP CAP [A]

L-HFC-W Tubing Head	Part Number	QTY
	30511	1



TOP PLATE [B]

L-HFC-W Tubing Head	Part Number	QTY
1 1/2"	3085	1
2 1/8"	3089	1
2 1/2"	3027	2
2 3/4"	3073	2



PACKING RUBBER [C]

L-HFC-W Tubing Head	Part Number	QTY
1 1/2"	3086	1
2 1/8"	3090	1
2 1/2"	3028	1
2 3/4"	3074	1



BOTTOM PLATE [D]

L-HFC-W Tubing Head	Part Number	QTY
1 1/2"	3087	1
2 1/8"	3029	1
2 1/2"	3029	1
2 3/4"	3075	1



SLIP ASSEMBLY AND SNAP RING [E]

L-HFC-W Tubing Head	Part Number	QTY
1 1/2"	30153402	1
2 1/8"	30153403	1
2 1/2"	30153404	1
2 3/4"	30153405	1



ADAPTER [F]

L-HFC-W Tubing Head	Part Number	QTY
Stripper Rubber Adapter with O-Ring	30154500	1
O-Ring	30565	1



STRIPPER RUBBER [G]

L-HFC-W Tubing Head	Part Number	QTY
1 1/2"	3011010	1
2 1/8"	3011010	1
2 1/2"	3011011	1



BODY [H]

L-HFC-W Tubing Head	Part Number	QTY
4 1/2" 8RD Male	30150000	1
4 1/2" 8RD Female	3095	1
5 1/2" 8RD Male	30150001	1
5 1/2" 8RD Female	3098	1
7" 8RD Male	30150003	1
7" 8RD Female	30101	1

TYPE L-HB TUBING HEAD

1,500 PSI Working Pressure

L-HBW TUBING HEAD WITH STRIPPER RUBBER

- 1,500 PSI working pressure
- Adapter with O-Ring: 20 lbs. (4 ½ & 5 ½ bodies)
- Adapter with O-Ring: 49.6 Lbs. (7 body)
- Stripper Rubber for 4 ½ & 5 ½ bodies: 2 ¾, 2 ⅞
- Stripper Rubber for 7 body: 2 ¾, 2 ⅞, 3 ½
- Stripper Rubbers are not designed to withstand full pressure rating

FEATURES:

- Full opening bore
- 8RD API top thread body
- Hinged Slips with Snap Ring
- Large diameter Top Cap with hammer lugs
- Stripper Rubber available
- Male or Female bottom connection available
- 3 8V side outlet option
- Mandrel option



HEAD COMPLETE

Bottom Connection (Inches)	4 ½ 8RD	5 ½ 8RD	7
Bore (Inches)	Full	Full	Full
Suspended String (Inches)	2 ¾, 2 ⅞	2 ¾, 2 ⅞	1 ½, 2 ¼, 2 ⅝, 2 ⅞, 3 ½
Max Slip Load Rating (lbs)	45,000	45,000	75,000
Cap Thread (Inches)	7 8RD	7 8RD	8 ¾ 8RD
Cap Material	Ductile Iron	Ductile Iron	Ductile Iron
Body Material	Ductile Iron	Ductile Iron	Carbon Steel
Height (Inches)	12	12	12
Weight (lbs)	65	65	125
Packing Rubber OD	6 ⅞	6 ⅞	7 ⅝



TOP CAP [A]	Part Number	QTY
L-HB Tubing Head 7"	301062	1
L-HB Tubing Head 4 ½" & 5 ½"	30105	1

TOP PLATE [B]	Part Number	QTY
L-HB Tubing Head 7"		
1 ½"	30249	1
2 ¼"	30251	1
2 ⅝"	30250	1
2 ⅞"	30252	1
3 ½"	30253	1
L-HB Tubing Head 4 ½" & 5 ½"		
2 ¾"	30166	1
2 ⅞"	30168	1

PACKING RUBBER [C]	Part Number	QTY
L-HB Tubing Head 7"		
Packing Rubber 7 ½" OD		
1 ½"	30152753	2
2 ¼"	30152763	2
2 ⅝"	30152754	2
2 ⅞"	30152755	2
3 ½"	30152756	2
L-HB Tubing Head 4 ½" & 5 ½"		
Packing Rubber 6 ⅞" OD		
2 ¾"	30152751	2
2 ⅞"	30152752	2





BOTTOM PLATE [D]

L-HB Tubing Head 7"	Part Number	QTY
1 1/2"	30263	1
2 1/8"	30265	1
2 3/8"	30264	1
2 7/8"	30266	1
3 1/2"	30267	1
L-HB Tubing Head 4 1/2" & 5 1/2"	Part Number	QTY
2 3/8"	30178	1
2 7/8"	30180	1



SLIP ASSEMBLY AND SNAP RING [E]

L-HB Tubing Head 7"	Part Number	QTY
1 1/2"	30153402	1
2 1/8"	30153403	1
2 3/8"	30153418	1
2 7/8"	30153419	1
3 1/2"	30153420	1
L-HB Tubing Head 4 1/2" & 5 1/2"	Part Number	QTY
2 3/8"	30153416	1
2 7/8"	30153417	1



SLIP BOWL [F]

L-HB Tubing Head 4 1/2" & 5 1/2"	Part Number	QTY
Slip Bowl	30112	1



STRIPPER RUBBER [G]

L-HB Tubing Head 7"	Part Number	QTY
Stripper Rubber		
7" 8R		
1 1/2"	3011018	1
2"	3011019	1
2 1/2"	3011020	1
3"	3011021	1
Stripper Rubber		
4 1/2" 8R & 5 1/2" 8R		
2 3/8"	3011015	1
2 7/8"	3011016	1



ADAPTER [H]

L-HB Tubing Head 4 1/2" & 5 1/2"	Part Number	QTY
Stripper Rubber Adapter with O-Ring	30154503	1
O-Ring	3042	1
L-HB 7"	30154504	1
O-Ring	3052	1



BODY [I]

L-HB Tubing Head 4 1/2" & 5 1/2"	Part Number	QTY
Body		
4 1/2" 8RD Male	30150010	1
4 1/2" 8RD Female	30157	1
5 1/2" 8RD Male	30150012	1
5 1/2" 8RD Male	30158	1
4 1/2" 8RD Male w/3" Outlet	30150013	1
5 1/2" 8RD Male w/3" Outlet	30150014	1
4 1/2" 8RD Female w/3" Outlet	30150265	1
5 1/2" 8RD Female w/3" Outlet	30150266	1
L-HB Tubing Head 7"	Part Number	QTY
Body		
7" 8RD Male	30150016	1
7" 8RD Female	30150267	1
7" 8RD Slip Joint	30150298	1
7" Male w/3" Outlet	30150017	1
7" Female w/3" Outlet	30150268	1
8 3/8" Male w/3" Outlet	30150050	1
8 3/8" Male w/2" Outlets	30150051	1

TYPE L-A7 TUBING HEAD

2,000 PSI Working Pressure

L-A7S TUBING HEAD WITH STRIPPER RUBBER

- 2,000 PSI working pressure
- Adapter with O-Ring: 49.6 Lbs
- Stripper Rubber for 4½, 5½ & 7 bodies: 1½, 2 ¼, 2 ¾, 2 ⅞, 3 ½
- Stripper Rubbers are not designed to withstand full pressure rating

FEATURES:

- Full opening bore on all body sizes
- 8RD API top thread body
- Hinged Slips with Snap Ring
- Large diameter Top Cap with hammer lugs
- Stripper Rubber available
- Male or Female bottom connection available
- Mandrel option



HEAD COMPLETE

	4 ½ 8RD	5 ½ 8RD	7 8RD
Bottom Connection (Inches)	4 ½ 8RD	5 ½ 8RD	7 8RD
Bore (Inches)	Full	Full	Full
Suspended String (Inches)	1 ½, 2 ¼, 2 ¾, 2 ⅞	1 ½, 2 ¼, 2 ¾, 2 ⅞, 3 ½	1 ½, 2 ¼, 2 ¾, 2 ⅞, 3 ½
Max Slip Load Rating (lbs)	85,000	85,000	85,000
Cap Thread (Inches)	8 ¾ 8RD	8 ¾ 8RD	8 ¾ 8RD
Cap Material	Ductile Iron	Ductile Iron	Ductile Iron
Body Material	Carbon Steel	Carbon Steel	Carbon Steel
Height (Inches)	13	13	13
Weight (lbs)	153	148	150
Packing Rubber OD	7 ¼	7 ¼	7 ¼



TOP CAP [A]

Type L-A7 Tubing Head	Part Number	QTY
	3044	1

TOP PLATE [B]

Type L-A7 Tubing Head	Part Number	QTY
1 ½"	30249	1
2 ¼"	30251	1
2 ¾"	30250	1
2 ⅞"	30252	1
3 ½"	30253	1
4"	301779	1
4 ½"	30401	1

PACKING RUBBER [C]

Type L-A7 Tubing Head	Part Number	QTY
1 ½"	30152764	2
2 ¼"	30152763	2
2 ¾"	30152754	2
2 ⅞"	30152755	2
3 ½"	30152756	2
4"	30152833	2
4 ½"	30152774	2



BOTTOM PLATE [D]

Type L-A7 Tubing Head	Part Number	QTY
1 1/2"	30263	1
2 1/8"	30265	1
2 3/8"	30264	1
2 7/8"	30266	1
3 1/2"	30267	1
4"	301781	1
4 1/2"	30369	1



SLIP ASSEMBLY AND SNAP RING [E]

Type L-A7 Tubing Head	Part Number	QTY
4 1/2" 8RD Body		
1 1/2"	30153402	1
2 1/8"	30153403	1
2 3/8"	30153418	1
2 7/8"	30153419	1
3 1/2"	30153420	1
5 1/2" 8RD Body, 7" 8RD		
1 1/2"	30153402	1
2 1/8"	30153403	1
2 3/8"	30153418	1
2 7/8"	30153419	1
3 1/2"	30153420	1
4"	30153489	1
4 1/2"	30153448	1



ADAPTER [F]

Type L-A7 Tubing Head	Part Number	QTY
Stripper Rubber adapter with O-Ring	30154507	1
O-Ring	3052	1



STRIPPER RUBBER [G]

Type L-A7 Tubing Head	Part Number	QTY
All body Sizes		
1 1/2"	3011018	1
2 1/8"	3011018	1
2 3/8"	3011019	1
2 7/8"	3011020	1
3 1/2"	3011021	1



BODY [H]

Type L-A7 Tubing Head	Part Number	QTY
4 1/2" 8RD Male	30150030	1
4 1/2" 8RD Female	30150269	1
5 1/2" 8RD Male	30150031	1
5 1/2" 8RD Female	30150270	1
7" 8RD Male	30150033	1
7" 8RD Female	30150272	1
7" Slip Joint	30150296	1
5 1/2" Slip Joint	30150505	1

TYPE L-SO TUBING HEAD

3,000 PSI Working Pressure

L-SOS TUBING HEAD WITH STRIPPER RUBBER

- 3,000 PSI working pressure
- Adapter with O-Ring: 49.6 lbs
- Stripper Rubber for all bodies: 1½, 2 ¼, 2 ¾, 2 ⅞, 3 ½
- Stripper Rubbers are not designed to withstand full pressure rating

FEATURES:

- Full opening bore
- 8RD API top thread body
- Hinged Slips with Snap Ring
- Large diameter Top Cap with hammer lugs
- Stripper Rubber available
- Male or Female bottom connection available
- Mandrel Option

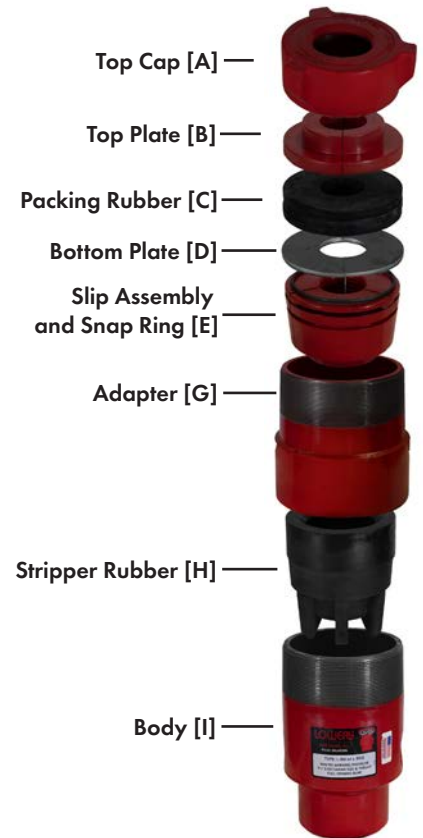

HEAD COMPLETE

	4 ½ 8RD	5 ½ 8RD	7 8RD
Bottom Connection (Inches)	4 ½ 8RD	5 ½ 8RD	7 8RD
Bore (Inches)	Full	Full	Full
Suspended String (Inches)	1 ½, 2 ¼, 2 ¾, 2 ⅞	1 ½, 2 ¼, 2 ¾, 2 ⅞, 3 ½	1 ½, 2 ¼, 2 ¾, 2 ⅞, 3 ½
Max Slip Load Rating (lbs)	120,000	120,000	120,000
Cap Thread (Inches)	8 ¾ 8RD	8 ¾ 8RD	8 ¾ 8RD
Cap Material	Ductile Iron	Ductile Iron	Ductile Iron
Body Material	Carbon Steel	Carbon Steel	Carbon Steel
Height (Inches)	14	14	14
Weight (lbs)	160	155	150



TOP CAP [A]

Part Number

QTY

L-SO Tubing Head

30311

1



TOP PLATE [B]

Part Number

QTY

L-SO Tubing Head

30394

1

1 ½"

30395

1

2 ¼"

30396

1

2 ¾"

30397

1

2 ⅞"

30398

1

3"



PACKING RUBBER [C]

L-SO Tubing Head

Part Number

QTY

1 ½"

30152763

3

2 ¼"

30152765

3

2 ¾"

30152766

3

2 ⅞"

30152767

3

3"

30152768

3





BOTTOM PLATE [D]

L-SO Tubing Head	Part Number	QTY
1 1/2"	30263	1
2 1/4"	30265	1
2 3/4"	30264	1
2 7/8"	30266	1
3"	30267	1



SLIP ASSEMBLY AND SNAP RING [E]

L-SO Tubing Head	Part Number	QTY
4 1/2" 8RD		
1 1/2"	30153402	1
2 1/4"	30153403	1
2 3/4"	30153418	1
2 7/8"	30153419	1
3"	30153420	1
5 1/2" 8RD		
1 1/2"	30153402	1
2 1/4"	30153403	1
2 3/4"	30153418	1
2 7/8"	30153419	1
3"	30153420	1
7" 8RD		
1 1/2"	30153402	1
2 1/4"	30153403	1
2 3/4"	30153418	1
2 7/8"	30153419	1
3 1/2"	30153420	1



ADAPTER [G]

L-SO Tubing Head	Part Number	QTY
Stripper Rubber Adapter with O-Ring	30154511	1
O-Ring	3052	1



STRIPPER RUBBER [H]

L-SO Tubing Head	Part Number	QTY
4 1/2" 8 RD		
1 1/2"	3011018	1
2 1/4"	3011018	1
2 3/4"	3011019	1
2 7/8"	3011020	1
3 1/2"	3011021	1
5 1/2" 8 RD		
1 1/2"	3011018	1
2 1/4"	3011018	1
2 3/4"	3011019	1
2 7/8"	3011020	1
3 1/2"	3011021	1
7" 8RD		
1 1/2"	3011018	1
2 1/4"	3011018	1
2 3/4"	3011019	1
2 7/8"	3011020	1
3 1/2"	3011021	1



BODY [I]

L-SO Tubing Head	Part Number	QTY
4 1/2" 8 RD Male	30150045	1
4 1/2" 8 RD Female	30150284	1
5 1/2" 8 RD Male	30150046	1
5 1/2" 8 RD Female	30150285	1
7" 8RD Male	30150047	1
7" 8RD Female	30150286	1

TYPE L-HHS TUBING HEAD

1,500 PSI Working Pressure

FEATURES:

- Full opening bore
- Hinged Slips
- Split Packing Gland
- 2" LP Side Outlets

Flat Cable Style (Shown Below)

#6	0.500 Inch
#4	0.562 Inch
#2	0.655 Inch

Round Cable Style (Shown Below)

#6	0.862 Inch
#4	1.01 Inch
#2	1.21 Inch

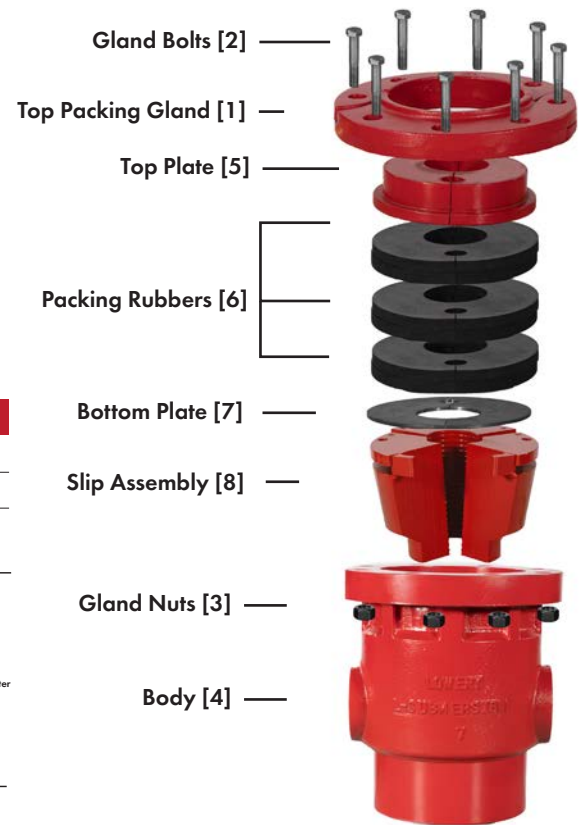
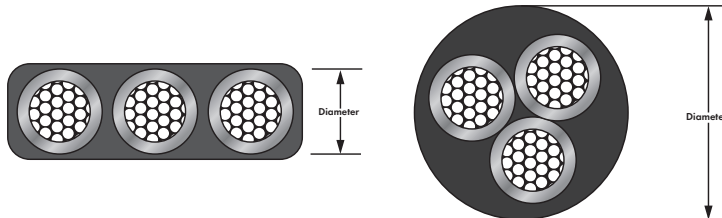

HEAD COMPLETE

Bottom Connection (Inches)	4 ½ 8RF	5 ½ 8RF	7 8RF
Suspended String (Inches)	2 ½ & 2 ¾	2 ½ & 2 ¾	2 ½ & 2 ¾
Max Slip Load Rating (lbs)	80,000	80,000	80,000
Packing Gland	8 Nuts & Bolts	8 Nuts & Bolts	8 Nuts & Bolts
Cap Material	Ductile Iron	Ductile Iron	Ductile Iron
Body Material	Ductile Iron	Ductile Iron	Ductile Iron
Height (Inches)	14	14	14
Weight (lbs)	175	170	165
Packing Rubber OD	7 ½	7 ½	7 ½



TOP PACKING GLAND [1]	Part Number	QTY
L-HHS 1500 PSI		
Top Packing Gland with Screws & Nuts		
Top Packing Gland	301976	1

GLAND BOLTS [2]	Part Number	QTY
L-HHS 1500 PSI		
¾" x 4 ¼" Grade 8 Hex Cap Screw	302107	8

GLAND NUTS [3]	Part Number	QTY
L-HHS 1500 PSI		
¾" Grade 8 Nut	302108	8



BODY [4]

L-HHS 1500 PSI	Part Number	QTY
4 1/2" 8RD Female	301977	1
5 1/2" 8RD Female	301978	1
7" 8RD Female	301979	1



TOP PLATE [5]

L-HHS 1500 PSI	Part Number	QTY
Flat Cable Style		
#6 2 3/8" w3 (.500) Holes	302104	1
a #6 2 3/8" W/3 (.500) Holes	302239	1
b #4 2 3/8" W/3 (.562) Holes	302242	1
c #4 2 3/8" W/3 (.562) Holes	302245	1
d #2 2 3/8" W/3 (.655) Holes	302248	1
Round Cable Style		
e #6 2 3/8" W/1 (.862) Hole	302251	1
f #6 2 3/8" W/1 (.862) Hole	302254	1
g #4 2 3/8" W/1 (1.01) Hole	302154	1
h #4 2 3/8" W/1 (1.01) Hole	302156	1
i #2 2 3/8" W/1 (1.21) Hole	302257	1
j #2 2 3/8" W/1 (1.21) Hole	302260	1
k 2 3/8" With no Hole	302169	1
l 2 3/8" with no Hole	302263	1



PACKING RUBBERS [6]

L-HHS 1500 PSI	Part Number	QTY
Flat Cable Style		
#6 2 3/8" w3 (.500) Holes	302105	3
a #6 2 3/8" W/3 (.500) Holes	302240	3
b #4 2 3/8" W/3 (.562) Holes	302243	3
c #4 2 3/8" W/3 (.562) Holes	302246	3
d #2 2 3/8" W/3 (.655) Holes	302249	3
Round Cable Style		
e #4 2 3/8" W/1 (1.01) hole	302166	3
f #4 2 3/8" W/1 (1.01) hole	302163	3
g #6 2 3/8" W/1 (.862) hole	302252	3
h #6 2 3/8" W/1 (.862) hole	302255	3
i #2 2 3/8" W/1 (1.21) hole	302258	3
j #2 2 3/8" W/1 (1.21) hole	302261	3
k 2 3/8" with no hole	302170	3
l 2 3/8" with no hole	302264	3



BOTTOM PLATE [7]

L-HHS 1500 PSI	Part Number	QTY
Flat Cable Style		
#6 2 3/8" w3 (.500) Holes	302106	1
a #6 2 3/8" W/3 (.500) Holes	302241	1
b #4 2 3/8" W/3 (.562) Holes	302244	1
c #4 2 3/8" W/3 (.562) Holes	302247	1
d #2 2 3/8" W/3 (.655) Holes	302250	1
Round Cable Style		
e #6 2 3/8" W/1 (.862) Hole	302253	1
f #6 2 3/8" W/1 (.862) Hole	302256	1
g #4 2 3/8" W/1 (1.01) Hole	302155	1
h #4 2 3/8" W/1 (1.01) Hole	302157	1
i #2 2 3/8" W/1 (1.21) Hole	302259	1
j #2 2 3/8" W/1 (1.21) Hole	302262	1
k 2 3/8" With no Hole	302171	1
l 2 3/8" with no Hole	302265	1



SLIP ASSEMBLY [8]

L-HHS 1500 PSI	Part Number	QTY
Flat Cable Style		
#6 2 3/8" w3 (.500) Holes	302035	1
a #6 2 3/8" W/3 (.500) Holes	302036	1
b #4 2 3/8" W/3 (.562) Holes	302035	1
c #4 2 3/8" W/3 (.562) Holes	302036	1
d #2 2 3/8" W/3 (.655) Holes	302035	1
Round Cable Style		
e #6 2 3/8" W/1 (.862) Hole	302035	1
f #6 2 3/8" W/1 (.862) Hole	302036	1
g #4 2 3/8" W/1 (1.01) Hole	302035	1
h #4 2 3/8" W/1 (1.01) Hole	302036	1
i #2 2 3/8" W/1 (1.21) Hole	302035	1
j #2 2 3/8" W/1 (1.21) Hole	302036	1
k 2 3/8" With no Hole	302035	1
l 2 3/8" with no Hole	302036	1

TYPE L-CE CASING HEAD

1,500 PSI Working Pressure

L-CE-B

Suspended String size for 8 3/4" body is 2 3/4", 2 7/8", 3 1/2"

FEATURES:

- Full opening bore
- 8RD API top thread body
- Hinged Slips with Snap Ring
- Large diameter Top Cap with hammer lugs
- Male or Female bottom connection available



HEAD COMPLETE		
Bottom Connection (Inches)	7	8 3/4"
Bore (Inches)	Full	Full
Suspended String (Inches)	4 1/2, 5 1/2	4 1/2, 5 1/2, 7
Max Slip Load Rating (lbs)	85,000	100,000
Cap Thread (Inches)	8 3/4 8RD	9 3/4 8RD
Cap Material	Ductile Iron	Ductile Iron
Body Material	Carbon Steel	Carbon Steel
Height (Inches)	11 1/2	12
Weight (lbs)	101	130
Packing Rubber OD	7 1/2	8 3/4"



TOP CAP [A]		
L-CE-B Casing Head 8 3/4"	Part Number	QTY
L-CE-B Casing Head 8 3/4"	30107	1
L-CE Casing Head 7"	301062	1
L-CE Casing Head 8 3/4"	30107	1

TOP PLATE [B]		
L-CE-B Casing Head 8 3/4"	Part Number	QTY
2 1/2"	30196	1
2 3/4"	30197	1
3 1/2"	30198	1
L-CE Casing Head 7"	Part Number	QTY
4 1/2"	30401	1
5 1/2"	30402	1
L-CE Casing Head 8 3/4"	Part Number	QTY
4 1/2"	30200	1
5 1/2"	30201	1
7"	30203	1

PACKING RUBBER [C]		
L-CE-B Casing Head 8 3/4"	Part Number	QTY
2 1/2"	30152776	2
2 3/4"	30152777	2
3 1/2"	30152778	2
L-CE Casing Head 7"	Part Number	QTY
4 1/2"	30152774	2
5 1/2"	30152775	2
L-CE Casing Head 8 3/4"	Part Number	QTY
4 1/2"	30152779	2
5 1/2"	30152780	2
7"	30152781	2

SLIP BOWL		
L-CE-B Casing Head 8 3/4"	Part Number	QTY
L-CE-B Casing Head 8 3/4"	30470	1



BOTTOM PLATE [D]		
L-CE-B Casing Head 8 3/4"	Part Number	QTY
2 1/2"	30212	1
2 3/4"	30213	1
3 1/2"	30214	1
L-CE Casing Head 7"	Part Number	QTY
4 1/2"	30369	1
5 1/2"	30370	1
L-CE Casing Head 8 3/4"	Part Number	QTY
4 1/2"	30216	1
5 1/2"	30217	1
7"	30219	1

SLIP ASSEMBLY AND SNAP RING [E]		
L-CE-B Casing Head 8 3/4"	Part Number	QTY
8 3/8" 8RD		
2 1/2"	30153451	1
2 3/4"	30153452	1
3 1/2"	30153453	1
L-CE Casing Head 7"	Part Number	QTY
4 1/2"	30153448	1
5 1/2"	30153449	1
L-CE Casing Head 8 3/4"	Part Number	QTY
8 3/8" 8RD		
4 1/2"	30153454	1
5 1/2"	30153455	1
7"	30153456	1

BODY [F]		
L-CE-B Casing Head 8 3/4"	Part Number	QTY
8 3/8" 8RD Male	30150753	1
8 3/8" 8RD Female	30151002	1
8 3/8" Slip Joint	30151251	1
L-CE Casing Head 7"	Part Number	QTY
7" 8RD Male	30150751	1
7" 8RD Female	30151000	1
L-CE Casing Head 8 3/4"	Part Number	QTY
8 3/8" 8RD Male	30150753	1
8 3/8" 8RD Female	30151002	1
8 3/8" Slip Joint	30151251	1

TYPE L-ECA CASING HEAD

1,500 PSI Working Pressure

L-ECA-B

Suspended String size for 8 3/8" body is 2 1/2", 2 7/8", 3 1/2"

FEATURES:

- Full opening bore on 7 & 8 3/8" bodies
- 8RD API top thread body
- Hinged Slips with Snap Ring
- Large diameter Top Cap with hammer lugs
- Male, Female, or Slip Joint bottom connection available



HEAD COMPLETE

	7	8 3/8"	9 5/8"	10 3/4"
Bottom Connection (Inches)	7	8 3/8"	9 5/8"	10 3/4"
Bore (Inches)	Full	Full	8 3/8"	8 3/8"
Suspended String (Inches)	4 1/2", 5 1/2"	4 1/2", 5 1/2", 7"	4 1/2", 5 1/2", 7"	4 1/2", 5 1/2", 7"
Max Slip Load Rating (lbs)	85,000	100,000	100,000	100,000
Cap Thread (Inches)	8 3/8" 8RD	10 3/8" 8RD	10 3/8" 8RD	10 3/8" 8RD
Cap Material	Ductile Iron	Ductile Iron	Ductile Iron	Ductile Iron
Body Material	Carbon Steel	Carbon Steel	Carbon Steel	Carbon Steel
Height (Inches)	11 1/2"	13"	13"	13"
Weight (lbs)	101	182	185	173
Packing Rubber OD	7 1/2"	9 1/8"	9 1/8"	9 1/8"



TOP CAP [A]	PART NUMBER	QTY
L-ECA-B Casing Head 8 3/8"	30312	1
L-ECA Casing Head 9 5/8" & 10 3/4"	30312	1
L-ECA Casing Head 7"	301062	1
L-ECA Casing Head 8 3/8"	30312	1

TOP PLATE [B]	Part Number	QTY
L-ECA-B Casing Head 8 3/8"	Part Number	QTY
2 1/2"	30467	1
2 7/8"	30471	1
3 1/2"	30474	1
L-ECA Casing Head 9 5/8" & 10 3/4"	Part Number	QTY
4 1/2"	30589	1
5 1/2"	30593	1
7"	30597	1
L-ECA Casing Head 7"	Part Number	QTY
4 1/2"	30401	1
5 1/2"	30402	1
L-ECA Casing Head 8 3/8"	Part Number	QTY
4 1/2"	30383	1
5 1/2"	30384	1
7"	30385	1

PACKING RUBBER [C]	Part Number	QTY
L-ECA-B Casing Head 8 3/8"	Part Number	QTY
2 1/2"	30152787	2
2 7/8"	30152788	2
3 1/2"	30152789	2
L-ECA Casing Head 9 5/8" & 10 3/4"	Part Number	QTY
4 1/2"	30152793	2
5 1/2"	30152794	2
7"	30152795	2
L-ECA Casing Head 7"	Part Number	QTY
4 1/2"	30152774	1
5 1/2"	30152775	1
L-ECA Casing Head 8 3/8"	Part Number	QTY
4 1/2"	30152790	2
5 1/2"	30152791	2
7"	30152803	2





BOTTOM PLATE [D]

L-ECA-B Casing Head 8 3/4"	Part Number	QTY
2 3/4"	30469	1
2 1/2"	30473	1
3 1/2"	30476	1
L-ECA Casing Head 9 3/4" & 10 3/4"	Part Number	QTY
4 1/2"	30591	1
5 1/2"	30595	1
7"	30599	1
L-ECA Casing Head 7"	Part Number	QTY
4 1/2"	30369	1
5 1/2"	30370	1
L-ECA Casing Head 8 3/4"	Part Number	QTY
4 1/2"	30389	1
5 1/2"	30390	1
7"	30391	1

SLIP ASSEMBLY AND SNAP RING [E]

L-ECA-B Casing Head 8 3/4"	Part Number	QTY
8 3/4" 8RD		
2 3/4"	30153451	1
2 1/2"	30153452	1
3 1/2"	30153453	1
L-ECA Casing Head 9 3/4" & 10 3/4"	Part Number	QTY
9 3/4" 8RD		
4 1/2"	30153448	1
5 1/2"	30153449	1
7"	30153466	1
10 3/4" 8RD		
4 1/2"	30153448	1
5 1/2"	30153449	1
7"	30153466	1
L-ECA Casing Head 7"	Part Number	QTY
7" 8RD		
4 1/2"	30153448	1
5 1/2"	30153449	
L-ECA Casing Head 8 3/4"	Part Number	QTY
8 3/4" 8RD		
4 1/2"	30153454	1
5 1/2"	30153455	1
7"	30153456	1

BODY [F]

L-ECA Casing Head 7"	Part Number	QTY
7" 8RD Male	30150760	1
7" 8RD Female	30151007	1
7" Slip Joint	30151256	1
L-ECA Casing Head 8 3/4"	Part Number	QTY
8 3/4" 8RD Male	30150761	1
8 3/4" 8RD Female	30151009	1
8 3/4" Slip Joint	30151257	1
9 3/4" 8RD Male	30150762	1
9 3/4" 8RD Female	30151010	1
10 3/4" 8RD Male	30150783	1

SLIP BOWL [G]

L-CE-B Casing Head 8 3/4"	30470	1
L-ECA Casing Head 9 3/4" & 10 3/4"	30619	1

TYPE L-MC CASING HEAD

1,500 & 2,000 PSI Working Pressure

FEATURES:

- Full opening bore on 7" body
- 8 3/8" 8RD API MOD top thread body
- Hinged Slips with Snap Ring
- Large diameter Top Cap with hammer lugs
- Male and Female connection available on 7"
- Male available on 8 3/8" only



HEAD COMPLETE 1,500 PSI

Bottom Connection (Inches)	7	8 3/8" Male Only
Bore (Inches)	Full	6.4
Suspended String (Inches)	4 1/2	4 1/2
Max Slip Load Rating (lbs)	90,000	90,000
Cap Thread (Inches)	8 3/8" 8RD API MOD	8 3/8" 8RD API MOD
Cap Material	Ductile Iron	Ductile Iron
Body Material	Carbon Steel	Carbon Steel
Height (Inches)	11"	11"
Weight (lbs)	83	101

HEAD COMPLETE 2,000 PSI

Bottom Connection (Inches)	7	8 3/8"
Bore (Inches)	Full	6.4
Suspended String (Inches)	4 1/2	4 1/2
Max Slip Load Rating (lbs)	90,000 lbs.	90,000 lbs.
Cap Thread (Inches)	8 3/8" 8RD API MOD	8 3/8" 8RD API MOD



TOP CAP [A]		
L-MC 1500 & 2000 Casing Head	PART NUMBER	QTY
Top Cap, 1500 PSI	301443	1
Top Cap, 2000 PSI	301755	1



TOP PLATE [B]		
L-MC 1500 & 2000 Casing Head	Part Number	QTY
4 1/2"	301436	1



PACKING RUBBER [C]		
L-MC 1500 & 2000 Casing Head 7 1/2" OD	Part Number	QTY
4 1/2"	301445	1



SLIP ASSEMBLY AND SNAP RING [D]		
L-MC 1500 & 2000 Casing Head	Part Number	QTY
4 1/2"	30153485	1



BODY [E]		
L-MC 1500 & 2000 Casing Head	Part Number	QTY
7" 8RD Male	30150781	1
7" 8RD Female	30151031	1
8 3/4" 8RD Male	30150782	1

TYPE L-CJ CASING HEAD

2,000 PSI Working Pressure

FEATURES:

- Full opening bore
- 8RD API top thread body
- Hinged Slips with Snap Ring
- Large diameter Top Cap with hammer lugs
- Male, Female, or Slip Joint bottom connection available



HEAD COMPLETE

Bottom Connection (Inches)	7	8	9	10	11 1/2 MALE ONLY
Bore (Inches)	Full	Full	Full	Full	10"
Suspended String (Inches)	4 1/2, 5	4 1/2, 5 1/2, 7	4 1/2, 5 1/2, 7	4 1/2, 5 1/2, 7, 8	4 1/2, 5 1/2, 7, 8
Max Slip Load Rating (lbs)	85,000	120,000	120,000	120,000	120,000
Cap Thread (Inches)	8 3/8 RD	10 3/8 RD	11 3/8 RD	11 3/8 RD	11 3/8 RD
Cap Material	Ductile Iron	Ductile Iron	Ductile Iron	Ductile Iron	Ductile Iron
Body Material	Carbon Steel	Carbon Steel	Carbon Steel	Carbon Steel	Carbon Steel
Height (Inches)	13	13 1/2	14 1/2	13	12 1/2
Weight (lbs)	126	189	242	211	234



TOP CAP [A]

L-CJ Casing Head	Part Number	QTY
9 3/8" 8RD	30313	1
10 3/8" 8RD	30313	1
11 3/8" 8RD	30313	1
L-CJ-B Casing Head	Part Number	QTY
9 3/8" 8RD	30313	1
10 3/8" 8RD	30313	1
11 3/8" 8RD	30313	1
L-CJ-B Casing Head 8 3/8"	Part Number	QTY
8 3/8" 8 RD	30312	1
L-CJ 7: Casing Head	Part Number	QTY
Top Cap for 4 1/2" Parts	30311	1
Top Cap for 5 1/2" Parts	30576	1

TOP PLATE [B]

L-CJ Casing Head	Part Number	QTY
L-CJ 7"		
4 1/2"	30403	
5 1/2"	30404	
L-CJ 8 3/8"	Part Number	QTY
4 1/2"	30383	1
5 1/2"	30384	1
7"	30385	1
L-CJ 9 3/8"-11 3/8"	Part Number	QTY
4 1/2"	30371	1
5 1/2"	30372	1
7"	30373	1
8 3/8"	30374	1
L-CJ-B 9 3/8"-11 3/8"	Part Number	QTY
2 3/8"	30490	1
2 3/4"	30494	1
3 1/2"	30497	1
L-CJ-B 8 3/8"	Part Number	QTY
2 3/8"	30467	1
2 3/4"	30471	1
3 1/2"	30474	1

PACKING RUBBER [C]

L-CJ Casing Head 10 3/8" OD	Part Number	QTY
4 1/2"	30152807	3
5 1/2"	30152808	3
7"	30152809	3
8 3/8"	30152811	3
L-CJ-B Casing Head 10 3/8" OD	Part Number	QTY
2 3/8"	30152804	3
2 3/4"	30152805	3
3 1/2"	30152806	3
L-CJ-B Casing Head 8 3/8" 9 3/8" OD	Part Number	QTY
2 3/8"	30152798	3
2 3/4"	30152799	3
3 1/2"	30152800	3
L-CJ 7: Casing Head 7 1/2" OD	Part Number	QTY
4 1/2"	30152796	3
5 1/2"	30152797	3
L-CJ Casing Head 8 3/8" 9 3/8" OD	Part Number	QTY
4 1/2"	30152801	3
5 1/2"	30152802	3
7"	30152803	3



BOTTOM PLATE [D]

L-CJ Casing Head 9 ½ & 10 ½	Part Number	QTY
4 ½"	30379	1
5 ½"	30380	1
7"	30381	1
8 ½"	30382	1
L-CJ-B Casing Head 9 ½ & 10 ½	Part Number	QTY
2 ½"	30492	1
2 ¾"	30496	1
3 ½"	30499	1
L-CJ-B Casing Head 8 ½"	Part Number	QTY
2 ½"	30469	1
2 ¾"	30473	1
3 ½"	30476	1
L-CJ 7: Casing Head	Part Number	QTY
4 ½"	30369	1
5 ½"	30370	1
L-CJ Casing Head 8 ¾"	Part Number	QTY
4 ½"	30389	1
5 ½"	30390	1
7"	30391	1

SLIP ASSEMBLY AND SNAP RING [E]

L-CJ Casing Head	Part Number	QTY
9 ½" 8RD Body		
4 ½"	30153454	1
5 ½"	30153455	1
7"	30153486	1
10 ¾" 8RD Body	Part Number	QTY
4 ½"	30153454	1
5 ½"	30153455	1
7"	30153486	1
8 ½"	30153469	1
11 ¾" 8RD Body	Part Number	QTY
4 ½"	30153454	1
5 ½"	30153455	1
7"	30153486	1
8 ½"	30153469	1
L-CJ-B Casing Head	Part Number	QTY
2 ½"	30153451	1
2 ¾"	30153452	1
3 ½"	30153453	1
L-CJ-B Casing Head 8 ¾"	Part Number	QTY
2 ½"	30153451	1
2 ¾"	30153452	1
3 ½"	30153453	1
L-CJ 7: Casing Head	Part Number	QTY
4 ½"	30153448	1
5 ½"	30153449	1
L-CJ Casing Head 8 ¾"	Part Number	QTY
4 ½"	30153454	1
5 ½"	30153455	1
7"	30153456	1

BODY [G]

L-CJ Casing Head	Part Number	QTY
9 ½" 8RD Male	30150769	1
9 ½" 8RD Female	30151018	1
9 ½" Slip Joint	30151265	1
10 ½" 8RD Male	30150770	1
10 ¾" 8RD Male	30151019	1
10 ¾" Slip Joint	30151266	1
11 ¾" 8RD Male	30150771	1
L-CJ-B Casing Head	Part Number	QTY
9 ½" 8RD Male	30150769	1
9 ½" 8RD Female	30151018	1
9 ½" Slip Joint	30151265	1
10 ½" 8RD Male	30150770	1
10 ¾" 8RD Male	30151019	1
10 ¾" Slip Joint	30151266	1
11 ¾" 8RD Male	30150771	1
L-CJ-B Casing Head 8 ¾"	Part Number	QTY
8 ½" 8 RD Male	30150768	1
8 ½" 8 RD Female	30151017	1
8 ½" Slip Joint	30151264	1
L-CJ 7: Casing Head	Part Number	QTY
7" 8RD Male	30150767	1
7" 8RD Female	30151016	1
7" Slip Joint	30151263	1
L-CJ Casing Head 8 ¾"	Part Number	QTY
8 ½" 8 RD Male	30150768	1
8 ½" 8 RD Female	30151017	1
8 ½" Slip Joint	30151264	1

SLIP BOWL [F]

L-CJ-B Casing Head 9 ½ & 10 ½	Part Number	QTY	
4 ½"	30470	30573	1
2 ¾"	30470	30573	1
3 ½"	30470	30573	1
L-CJ-B Casing Head 8 ¾"	Part Number	QTY	
30470		1	

TYPE L-MS TUBING HEAD

1,500 PSI Working Pressure

L-MS TUBING HEAD WITH STRIPPER RUBBER

- 1,500 PSI working pressure
- Adapter with O-Ring: 9.70 Lbs
- Stripper Rubber available for all sizes
- Stripper Rubbers are not designed to withstand full pressure rating.

FEATURES:

- Seamless steel Body
- Full bore on 4 ½ Body
- 1 ¾ compact Slip length
- Full flow through outlet; no restrictions
- Hinged Slip segments with Snap Ring
- Male or Female bottom connection available



HEAD COMPLETE			
Bottom Connection (Inches)	4 ½ 8RD	5 ½ 8RD	7 8RD
Bore (Inches)	Full	4	4
Suspended String (Inches)	1 ½, 2 ¾	1 ½, 2 ¾	1 ½, 2 ¾
Max Slip Load Rating (lbs)	45,000	45,000	45,000
Cap Thread (Inches)	5 ½ 8RD	5 ½ 8RD	5 ½ 8RD
Cap Material	Ductile Iron	Ductile Iron	Ductile Iron
Body Material	Carbon Steel	Carbon Steel	Carbon Steel
Height (Inches)	9	10	11
Weight (lbs)	44	46	55
Packing Rubber OD	4 ¾	4 ¾	4 ¾



TOP CAP [A]

L-MS Tubing Head	Part Number	QTY
	30944	1



TOP PLATE [B]

L-MS Tubing Head	Part Number	QTY
1 1/2"	30945	1
2 1/2"	30948	1



PACKING RUBBER [C]

L-MS Tubing Head	Part Number	QTY
Packing Rubber 1 1/2" (4 1/2" OD)	30152761	2
Packing Rubber 2 1/2" (4 1/2" OD)	30152762	2



SLIP ASSEMBLY AND SNAP RING [D]

L-MS Tubing Head	Part Number	QTY
Slip for 4 1/2", 5 1/2", 7"		
1 1/2"	30153423	1
2 1/2"	30153425	1



ADAPTER [E]

L-MS Tubing Head	Part Number	QTY
Stripper Rubber adapter with O-Ring	30154505	1
O-Ring	30957	1



STRIPPER RUBBER [F]

L-MS Tubing Head	Part Number	QTY
Stripper Rubber for 4 1/2", 5 1/2", 7"		
1 1/2"	30961	1
2 1/2"	30962	1



BODY [G]

L-MS Tubing Head	Part Number	QTY
4 1/2" 8RD Male	30150019	1
4 1/2" 8RD Female	30150250	1
5 1/2" 8RD Male	30150020	1
5 1/2" 8RD Female	30150251	1
7" 8RD Male	30150021	1
7" 8RD Female	30150252	1

TYPE L-SW TUBING HEAD

1,500 PSI Working Pressure

L-SWS TUBING HEAD WITH STRIPPER RUBBER

- 1,500 PSI working pressure
- Adapter with O-Ring: 26.1 lbs
- Stripper Rubbers are not designed to withstand full pressure rating

FEATURES:

- Seamless steel Body
- Full opening bore on all sizes
- Hinged Slips segments with Snap Ring
- Stripper Rubber available
- Male or Female bottom connection available



HEAD COMPLETE		
Bottom Connection (Inches)	4 ½ 8RD	5 ½ 8RD
Bore (Inches)	Full	Full
Suspended String (Inches)	2 ¼, 2 ½	2 ¼, 2 ½, 3 ½
Max Slip Load Rating (lbs)	65,000	65,000
Cap Thread (Inches)	6 ¾ 6V	6 ¾ 6V
Cap Material	Ductile Iron	Ductile Iron
Body Material	Carbon Steel	Carbon Steel
Height (Inches)	10	10
Weight (lbs)	78	74
Packing Rubber OD	5 ¼	5 ¼



TOP CAP [A]		
L-SW Tubing Head 4 1/2" & 5 1/2"	Part Number	QTY
	301080	1



TOP PLATE [B]		
L-SW Tubing Head 4 1/2" & 5 1/2"	Part Number	QTY
1 1/2"	301092	1
2 3/4"	301093	1
2 7/8"	301094	1
3 1/2"	301086	1



PACKING RUBBER [C] 5 3/4" OD		
L-SW Tubing Head	Part Number	QTY
1 1/2"	301095	1
2 3/4"	301096	1
2 7/8"	301097	1
3 1/2"	30152831	2



BOTTOM PLATE [D]		
L-SW Tubing Head	Part Number	QTY
1 1/2"	301098	1
2 3/4"	301099	1
2 7/8"	301100	1
3 1/2"	301088	1



SLIP ASSEMBLY AND SNAP RING [E]		
L-SW Tubing Head	Part Number	QTY
4 1/2" 8R		
1 1/2"	30153406	1
2 3/4"	30153407	1
2 7/8"	30153408	1
5 1/2" 8R		
1 1/2"	30153406	1
2 3/4"	30153407	1
2 7/8"	30153408	1
3 1/2" (Only 5 1/2" Body)	30153418	1



STRIPPER RUBBER [F]		
L-SW Tubing Head	Part Number	QTY
4 1/2" 8RD & 5 1/2" 8 RD		
1 1/2"	301108	1
2 3/4"	301109	1
2 7/8"	301110	1



ADAPTER [G]		
L-SW Tubing Head	Part Number	QTY
O-Ring	301107	1
Stripper Rubber Adapter With O-Ring	30154501	1



BODY [H]		
L-SW Tubing Head	Part Number	QTY
4 1/2" 8 RD Male	30150005	1
4 1/2" 8 RD Female	30150260	1
5 1/2" 8 RD Male	30150006	1
5 1/2" 8 RD Female	30150261	1

405-677-7222
 sales@wnsoilfield.com
 www.wnsoilfield.com

TYPE L-S TUBING HEAD

1,500 PSI Working Pressure

L-SS TUBING HEAD WITH STRIPPER RUBBER

- 1,500 PSI working pressure
- Adapter with O-Ring: 17 lbs
- Stripper Rubber for sizes available: 1, 1 1/2, 2 1/8, 2 3/8
- Stripper Rubbers are not designed to withstand full pressure rating.

FEATURES:

- Seamless steel Body
- Full bore 2 3/8 through 4 1/2 bodies
- Full 2 3/4 Slip length
- Hinged Slip segments with Snap Ring
- Stripper Rubber available in all sizes except 2 3/8
- Male or Female bottom connection available



HEAD COMPLETE

Bottom Connection (Inches)	2 3/8 8RD	2 3/8 8RD	3 1/2 8RD	3 1/2 10RD MALE ONLY	4 1/2 8RD	5 1/2 8RD	7 8RD
Bore (Inches)	Full	Full	Full	Full	Full	4	4
Suspended String (Inches)	1, 1 1/4	1, 1 1/4, 1 1/2, 2 1/8	1, 1 1/4, 1 1/2, 2 1/8	1, 1 1/4, 1 1/2, 2 1/8	1, 1 1/4, 1 1/2, 2 1/8, 2 3/8, 2 3/4	1, 1 1/4, 1 1/2, 2 1/8, 2 3/8, 2 3/4	1, 1 1/4, 1 1/2, 2 1/8, 2 3/8, 2 3/4
Max slip load rating (lbs)	45,000	45,000	45,000	45,000	45,000	45,000	45,000
Cap thread (Inches)	5 1/2 8RD	5 1/2 8RD	5 1/2 8RD	5 1/2 8RD	5 1/2 8RD	5 1/2 8RD	5 1/2 8RD
Cap material	Ductile Iron	Ductile Iron	Ductile Iron	Ductile Iron	Ductile Iron	Ductile Iron	Ductile Iron
Body material	Carbon Steel	Carbon Steel	Carbon Steel	Carbon Steel	Carbon Steel	Carbon Steel	Carbon Steel
Height (Inches)	10	10	10	10	9	10	11
Weight (lbs)	51	48	46	46	46	47	57
Packing Rubber OD	4 3/4	4 3/4	4 3/4	4 3/4	4 3/4	4 3/4	4 3/4



TOP CAP [A]

L-S Tubing Head	Part Number	QTY
	30944	1

TOP PLATE [B]

L-S Tubing Head	Part Number	QTY
1"	301010	1
1 1/4"	301013	1
1 1/2"	30945	1
2 1/8"	301016	1
2 3/8"	30948	1
2 3/4"	30951	1

PACKING RUBBER [C] 4 3/4" OD

L-S Tubing Head	Part Number	QTY
1"	301011	1
1 1/4"	30152759	2
1 1/2"	30152761	2
2 1/8"	301017	1
2 3/8"	30152762	2
2 3/4"	30952	1





SLIP ASSEMBLY AND SNAP RING [D]

L-S Tubing Head	Part Number	QTY
Slip		
2 7/8" 8RD Body		
1"	30153428	1
1 1/4"	30153430	1
2 7/8" 8RD Body		
1"	30153428	1
1 1/4"	30153430	1
1 1/2"	30153432	1
2 7/8"	30153434	1
3 1/2" 8RD Body		
1"	30153428	1
1 1/4"	30153430	1
1 1/2"	30153432	1
2 7/8"	30153434	1
2 3/4"	30153435	1
3 3/2" 10RD Body		
1"	30153428	1
1 1/4"	30153430	1
1 1/2"	30153432	1
2 7/8"	30153434	1
2 3/4"	30153435	1
2 7/8"	30153436	1
5 1/2" 8RD Body		
1"	30153428	1
1 1/4"	30153430	1
1 1/2"	30153432	1
2 7/8"	30153434	1
2 3/4"	30153435	1
2 7/8"	30153436	1
7 1/2" 8RD Body		
1"	30153428	1
1 1/4"	30153430	1
1 1/2"	30153432	1
2 7/8"	30153434	1
2 3/4"	30153435	1
2 7/8"	30153436	1



ADAPTER [E]

L-S Tubing Head	Part Number	QTY
Stripper Rubber Adapter with O-Ring	30154506	1
O-Ring	30957	1



STRIPPER RUBBER [F]

L-S Tubing Head	Part Number	QTY
Stripper Rubber		
4 1/2" 8RD		
1"	301019	1
1 1/2"	30961	1
2 7/8"	30961	1
2 3/4"	30962	1
5 1/2" 8RD		
1"	301019	1
1 1/2"	30961	1
2 7/8"	30961	1
2 3/4"	30962	1
7" 8RD		
1"	301019	1
1 1/2"	30961	1
2 7/8"	30961	1
2 3/4"	30962	1



BODY [G]

L-S Tubing Head	Part Number	QTY
2 7/8" 8RD Male	30150022	1
2 7/8" 8RD Female	30150253	1
2 7/8" 8RD Male	30150023	1
2 7/8" 8RD Female	30150254	1
3 1/2" 8RD Male	30150024	1
3 1/2" 8RD Female	30150255	1
3 3/4" 10RD Male	30150025	1
7" 8RD Male	30150 028	1
7" 8RD Female	30150259	1
4 1/2" 8RD Male	30150026	1
4 1/2" 8RD Female	30150256	1
5 1/2" 8RD Male	30150027	1
5 1/2" 8RD Female	30150257	1

TYPE L-HW TUBING HEAD

2,000 PSI Working Pressure

L-HWS TUBING HEAD WITH STRIPPER RUBBER

- 2,000 PSI working pressure
- Adapter with O-Ring: 52.6 lbs
- Stripper Rubbers available in 2 3/4", 2 1/2"
- Stripper Rubbers are not designed to withstand full pressure rating.

FEATURES:

- Seamless steel Body
- Full opening bore on all sizes
- Hinged Slips with Snap Ring
- Stripper Rubber available
- Male or Female bottom connection available

- Top Cap [A] —
- Top Plate [B] —
- Packing Rubber [C] —
- Bottom Plate [D] —
- Slip Assembly and Snap Ring [E] —
- Slip Bowl [F] —
- Adapter [G] —
- Stripper Rubber [H] —
- Body [I] —



HEAD COMPLETE

Bottom Connection (Inches)	4 1/2 8RD	5 1/2 8RD	7 8RD FEMALE ONLY
Bore (Inches)	Full	Full	Full
Suspended String (Inches)	2 3/4, 2 1/2	2 3/4, 2 1/2	2 3/4, 2 1/2
Max Slip Load Rating (lbs)	80,000	80,000	80,000
Cap Thread (Inches)	8 1/4 6V	8 1/4 6V	8 1/4 6V
Cap Material	Ductile Iron	Ductile Iron	Ductile Iron
Body Material	Carbon Steel	Carbon Steel	Carbon Steel
Height (Inches)	12	12	12
Weight (lbs)	117	112	120
Packing Rubber OD	7 1/4	7 1/4	7 1/4



TOP CAP [A]

L-HW Tubing Head	Part Number	QTY
	301126	1

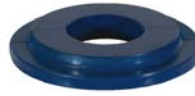

TOP PLATE [B]

L-HW Tubing Head	Part Number	QTY
2 3/8"	301127	1
2 7/8"	301130	1



PACKING RUBBER [C] 7 1/4" OD

L-HW Tubing Head	Part Number	QTY
2 3/8"	30773	1
2 7/8"	30774	1



BOTTOM PLATE [D]

L-HW Tubing Head	Part Number	QTY
2 3/8"	30781	1
2 7/8"	30782	1



SLIP ASSEMBLY AND SNAP RING [E]

L-HW Tubing Head	Part Number	QTY
4 1/2" 8RD Body		
2 3/8"	30153439	1
2 7/8"	30153440	1
5 1/2" 8RD Body		
2 3/8"	30153439	1
2 7/8"	30153440	1
7" 8 RD Body		
2 3/8"	30153439	1
2 7/8"	30153440	1



SLIP BOWL [F]

L-HW Tubing Head	Part Number	QTY
	301133	1



ADAPTER [G]

L-HW Tubing Head	Part Number	QTY
Stripper Rubber Adapter with O-Ring	30154508	1
O-Ring	3052	1



STRIPPER RUBBER [H]

L-HW Tubing Head	Part Number	QTY
4 1/2" 8RD Body		
2 3/8"	301136	1
2 7/8"	301137	1
5 1/2" 8RD Body		
2 3/8"	301136	1
2 7/8"	301137	1
7" 8 RD Body		
2 3/8"	301136	1
2 7/8"	301137	1



BODY [I]

L-HW Tubing Head	Part Number	QTY
4 1/2" 8RD Male	30150036	1
4 1/2" 8RD Female	30150273	1
5 1/2" 8RD Male	30150037	1
5 1/2" 8RD Female	30150274	1
7" 8RD Female	30150275	1

TYPE L-MSR CASING HEAD

1,500 & 2,000 PSI Working Pressure

FEATURES:

- Full opening bore on 7" body
- 8RD API top thread body
- Hinged Slips with Snap Ring
- Large diameter Top Cap with hammer lugs
- Male, Female, or Slip Joint bottom connection available



HEAD COMPLETE 1,500 PSI		
Bottom Connection (Inches)	7	8 ½
Bore (Inches)	Full	6 ¾
Suspended String (Inches)	4 ½, 5 ½	4 ½, 5 ½
Max Slip Load Rating (lbs)	90,000	90,000
Cap Thread (Inches)	8 ¾ 8RD	8 ¾ 8RD
Cap Material	Ductile Iron	Ductile Iron
Body Material	Carbon Steel	Carbon Steel
Height (Inches)	11 ½	11 ½
Weight (lbs)	97	106

HEAD COMPLETE 2,000 PSI		
Bottom Connection (Inches)	7	8 ¾
Bore (Inches)	Full	6 ¾
Suspended String (Inches)	4 ½, 5 ½	4 ½, 5 ½
Max Slip Load Rating (lbs)	90,000 lbs.	90,000 lbs.
Cap Thread (Inches)	8 ¾ 8RD	8 ¾ 8RD
Cap Material	Ductile Iron	Ductile Iron



TOP CAP [A]

Top Cap for 1500 PSI	Part Number	QTY
7" 8RD	30924	1
8 1/2" 8RD	30924	1
Top Cap for 2000 PSI	Part Number	QTY
7" 8RD	3044	1
8 1/2" 8RD	3044	1



TOP PLATE [B]

Top Plate for 1500 & 2000 PSI	Part Number	QTY
4 1/2"	30925	1
5 1/2"	30929	1



PACKING RUBBER [C] 7 3/4" OD

Packing Rubber for 1500 & 2000 PSI	Part Number	QTY
4 1/2"	30926	1
5 1/2"	30930	1



BOTTOM PLATE [D]

Bottom Plate for 1500 & 2000 PSI	Part Number	QTY
4 1/2"	30927	1
5 1/2"	90931	1



SLIP ASSEMBLY AND SNAP RING [E]

Slip Assembly & Snap Ring for 1500 & 2000 PSI	Part Number	QTY
7" 8RD Body		
4 1/2"	30153464	1
5 1/2"	30153465	1
8 1/2" 8RD Body		
4 1/2"	30153464	1
5 1/2"	30153465	1



BODY [F]

Body for 1500 & 2000 PSI	Part Number	QTY
7" 8RD Male	30150756	1
7" 8RD Female	30151004	1
7" 8RD Slip Joint	30151253	1
8 1/2" 8RD Male	30150757	1
8 1/2" 8RD Female	30151006	1
8 1/2" 8RD Slip Joint	30151255	1



Wellhead Accessories and Flanges

SLIP JOINT BELLED NIPPLES



4 ½ 8RD Thread



5 ½ 8RD Thread



7 8RD Thread



8 ½ 8RD Thread



9 ½ 8RD Thread



4 ½ 8RD Thread



5 ½ 8RD Thread

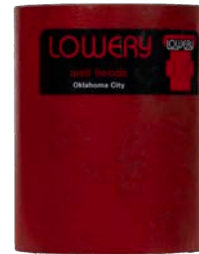

4 ½ 8RD Thread

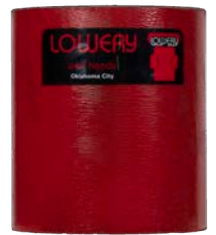

5 ½ 8RD Thread

Schedule N-80 Standard 8 RD Thread is Standard

CASING SIZE (INCHES)	PART NUMBER	WT. (LBS)
4 ½ 8RD Thread	30102550	7
5 ½ 8RD Thread	30102551	11
7 8RD Thread	30102552	13
8 ½ 8RD Thread	30102553	18
9 ½ 8RD Thread	30102554	32

Schedule J-55

CASING SIZE (INCHES)	PART NUMBER	WT. (LBS)
4 ½ 8RD Thread	30292055	6
5 ½ 8RD Thread	30293055	7

Slip Couplings

CASING SIZE (INCHES)	PART NUMBER	WT. (LBS)
4 ½ 8RD Thread	30569	7
5 ½ 8RD Thread	30570	9.6
7 8RD Thread	30571	19.4
8 5/8 8RD Thread	30572	27

FITTINGS



Bull Plug

Bull Plug

BULL PLUGS	PART NUMBER
2 1/2" 8RD, XH, 1/2" NPT Tapped End	302120
2 3/4" 8RD, XH, 1/2" NPT Tapped End	302136
2 7/8" 8RD, XXH	302216
2 3/4" 8RD, XXH, 1/2" NPT Tapped End	302221
3 1/2" 8RD, XXH, 1/2" NPT Tapped End	302180
4 1/2" 8RD, STD(S40), 1/2" NPT Tapped End	302095
2 7/8" 8RD, XH	30645
3 1/2" 8RD, XH	302089
2 3/4" 8RD, XH	30644
2 3/4" 8RD	302079
2", 1 1/2"	302080
2 3/4" 8RD, XXH	302132
2 3/4" 8RD, 1/2" NPT Tapped End	302136
2 7/8" 8R, 1/2" NPT Tapped End	302137
2 3/4" 8R	302078
2 3/4" 8RD, XXH, 1/2" NPT Tapped End	302133

COUPLINGS	PART NUMBER
2 3/4" 8RD F x 2 3/4" 8RD F, STD(S40)	302090



Nipple



Nipple



Nipple

NIPPLES	PART NUMBER
2 1/4" 8RD M x 2 1/4" 8RD M STD(S40) x 8"	302087
2 7/8" 8RD M x 2 3/4" 8RD M S40 x 6", 3000psi WP	302091
2 3/4" 8RD M x 2" 1 1/2" M S40 x 6"	302065
2 3/4" 8RD M x 2" 1 1/2" M XH(S80) x 6"	302061
2 7/8" 8RD M x 2" 1 1/2" M S40 x 6"	302060
2 7/8" 8RD M x 2 3/4" 8RD M S40 x 6", 3000psi WP	301532
2 7/8" 8RD M x 2 3/4" 8RD M XH(S80) x 8"	302181
2 7/8" 8RD M x 2 3/8" 8RD M XH(S80) x 6"	302121
2 3/4" 8RD M x 2" 1 1/2" M XH(S80) x 6"	302084
2 3/4" 8RD M x 2" 1 1/2" M XH(S80) x 8"	302081
3 1/2" 8RD M x 2" 1 1/2" M XH(S80) x 8"	302088
2 7/8" 8RD M x 2 3/4" 8RD M S40 x 6"	302164
3 1/2" 8R M x 3" 8V M S40 x 8"	302082
3" 8V M x 2 7/8" 8RD M S40 x 8"	302075
3" 8V M x 2 7/8" 8RD M XH(S80) x 8"	302076
3" 8V M x 2 3/4" 8RD M S40 x 8"	302063
3" 8V M x 2 3/4" 8RD M XH(S80) x 8"	302064
2 3/4" 8RD M x 2 3/8" 8RD M S40 x 6"	302062
2 3/4" 8RD M x 2 3/8" 8RD M S40 x 6", 3000psi WP	302092
3 1/2" 8V M x 2" 8RD M S40 x 8"	302063
2 3/8" 8RD M x 2 3/8" 8RD M x 6" XH	302146

CASING SUPPORTS

FEATURES:

- Short compact design
- Shouldered seats to centralize support body on surface strings
- Body will fit either pipe or coupling
- Hinged slips with handles



CASING SIZE OF COUPLING (INCHES)	SUSPENDED STRING SIZE (INCHES)
7 through 8 3/8	2 3/4, 2 3/8, 3 1/8
7 through 8 3/8	4 1/2, 5 1/8
8 3/8 through 10 1/4	4 1/2, 5 1/8
8 3/8 through 10 1/4	7

CASING SIZE	COMPLETE ASSEMBLY PART NUMBER	SLIP WITH HANDLES ONLY PART NUMBER
7" thru 8 3/8"		
Slips		
2 3/8"	30204290	30154250
2 7/8"	30204291	30154251
3 1/2"	30204292	30154252
4 1/2"	30204293	30154253
5 1/2"	30204294	30154254
8 3/8" thru 10 1/4"		
Slips		
4 1/2"	30204295	30154257
5 1/2"	30204296	30154258
7"	30204297	30154259

FLANGES

612 Flanges Features:

- 7 1/16" Bore Size
- 612 Package parts in 2 3/8", 2 7/8", 3 1/2 inches
- Available in 2M, 3M, 5M, or 10M
- 2M/3M Double drilled
- Utilizes L-R slips
- Custom sizes available



FLANGE ONLY	PART NUMBER	QTY
7 1/16" 2000 - 3000 Psi lowery slip type (612) adapter flange only	302004	1
7 1/16" 2000--3000 (6"600-900) Flange & body for (612) 3 1/2" slip type hanger flange	301971	1
7 1/16" 3000 Psi lowery slip type (612) adapter flange only	302165	1
7 1/16" 3m flange for (612) 3 1/2" slip type hanger flange	302179	1
7 1/16" 5m lowery slip type (612) adapter flange only	301995	1
7 1/16" 5m flange for (612) 3 1/2" slip type hanger flange	302074	1
7 1/16" 5m lowery slip type (612) adapter flange only with 1/2" npt port	302217	1
7 1/16" 10m lowery slip type (612) adapter flange only	301959	1
7 1/16" 10m flange for (612) 3 1/2" slip type hanger flange	302025	1
7 1/16" 10m lowery slip type (612) adapter flange only with 1/2" npt hole	302128	1

COMPLETE ASSEMBLY	PART NUMBER	QTY
7 1/16" 2M/3M PSI W / P (6" 600--- 900 #) RTJ X 2 3/8" Lowery Slip Type (612) Hanger Flange Assembly	30102426	1
7 1/16" 2M/3M PSI W / P (6" 600--- 900 #) RTJ X 2 7/8" Lowery Slip Type (612) Hanger Flange Assembly	30102423	1
7 1/16" 2M/3M PSI W / P (6" 600--- 900 #) RTJ X 3 1/2" Lowery Slip Type (612) Hanger Flange Assembly	20102417	1
7 1/16" 3M PSI W / P (900 #) RTJ X 2 3/8" Lowery Slip Type (612) Hanger Flange Assembly	30102448	1
7 1/16" 3M PSI W / P (900 #) RTJ X 2 7/8" Lowery Slip Type (612) Hanger Flange Assembly	30102447	1
7 1/16" 3M PSI W / P (900 #) RTJ X 3 1/2" Lowery Slip Type (612) Hanger Flange Assembly	30102449	1
7 1/16" 5M X 2 3/8" Lowery Slip Type (612) Adapter Flange Assembly	30102421	1
7 1/16" 5M X 2 7/8" Lowery Slip Type (612) Adapter Flange Assembly	30102420	1
7 1/16" 5M X 3 1/2" Lowery Slip Type (612) Adapter Flange Assembly	30102433	1
7 1/16" 5M X 2 3/8" Lowery Slip Type (612) Adapter Flange Assembly With 1/2" NPT Port	30102451	1
7 1/16" 10M X 2 3/8" Lowery Slip Type (612) Adapter Flange Assembly	30102418	1
7 1/16" 10M X 2 7/8" Lowery Slip Type (612) Adapter Flange Assembly	30102415	1
7 1/16" 10M X 3 1/2" Lowery Slip Type (612) Adapter Flange Assembly	30102425	1
7 1/16" 10M X 2 3/8" Lowery Slip Type (612) Adapter Flange Assembly With 1/2" NPT Hole	30102446	1

PARTS	PART NUMBER	QTY
Ring		
2 3/8" & 2 7/8"	301895	1
3 1/2"	301972	1
Top Plate		
2 3/8"	301896	1
2 7/8"	301897	1
3 1/2"	301961	1
Packing Rubber		
2 3/8"	301898	1
2 7/8"	301899	1
3 1/2"	301960	
Bottom Plate		
2 3/8"	301900	1
2 7/8"	301901	1
3 1/2"	301962	1
Slip		
2 3/8"	30102861	1
2 7/8"	30102862	1
3 1/2"	30102864	1
Bolts Grade 5		
3/8" X 2 1/4"	301902	8

FLANGES



Standard KTH Flange Features:

- 7 1/16" Bore size
- L-SW Package parts in 2 3/8", 2 7/8", 3 1/2" inches
- 2M/3M Double drilled

COMPLETE ASSEMBLY	PART NUMBER	QTY
7 1/16" 2M/3M PSI W / P (6" 600--- 900 #) RTJ X 2 3/8" Lowery Slip Type Hanger Flange Assembly	30102434	1
7 1/16" 2M/3M PSI W / P (6" 600--- 900 #) RTJ X 2 7/8" Lowery Slip Type Hanger Flange Assembly	30102435	1
7 1/16" 2M/3M PSI W / P (6" 600--- 900 #) RTJ X 3 1/2" Lowery Slip Type Hanger Flange Assembly	30102436	1

PART	PART NUMBER	QTY
Flange Only	302083	1
Ring	301360	1
Top Plate		
2 3/8"	301093	1
2 7/8"	301094	1
3 1/2"	301086	1
Packing Rubber		
2 3/8"	301096	1
2 7/8"	301097	1
3 1/2"	30152831	2
Bottom Plate		
2 3/8"	301099	1
2 7/8"	301100	1
3 1/2"	301088	1
Slip		
2 3/8"	30153407	1
2 7/8"	30153408	1
3 1/2"	30153412	1
Bolts		
3/8" X 2 1/4"	305178	8

FLANGES

B-1 Type Hanger Flange Features:

- Flange Size
- 7 1/16"
- Tubing size is 2 3/8", 2 7/8", or 3 inch thread
- Available in 2M/3M, 5M, or 10 M
- One piece, no weld
- Custom Sizes Available



DESCRIPTION	PART NUMBER
7 1/16" 2M/3M PSI Lowery Threaded Type Hgr Flange, With 2 3/8" 8 Rd Top & Bottom Thread, With R-45 Ring Joint Groove	30102437
7 1/16" 2M/3M PSI Lowery Threaded Type Hgr Flange, With 2 7/8" 8 Rd Top & Bottom Thread, With R-45 Ring Joint Groove	30102438
7 1/16" 2M/3M PSI Lowery Threaded Type Hgr Flange, With 3 1/2" 8 Rd Top & Bottom Thread, With R-45 Ring Joint Groove	30102450
7 1/16" 3M PSI W / P Lowery Threaded Type Hanger Flange, With 2 7/8" 8 Rd Eue Male Top Thread X 2 3/8" 8 Rd Eue Female Bottom Thread, With R-45 Ring Joint Groove	30102375
7 1/16" 3M PSI W / P Lowery Threaded Type Hanger Flange, With 2 7/8" 8 Rd Eue Male Top Thread X 2 7/8" 8 Rd Eue Female Bottom Thread, With R-45 Ring Joint Groove	30102376
7 1/16" 3M PSI Lowery Threaded Type Hanger Flange, With 3 1/2" 8 Rd Top & Bottom Thread, With R-45 Ring Joint Groove	30102445
7 1/16" 5M PSI W / P Lowery Threaded Type Hanger Flange, With 2 7/8" 8 Rd Eue Male Top Thread X 2 3/8" 8 Rd Eue Female Bottom Thread, With R-46 Ring Joint Groove	30102307
7 1/16" 5M PSI W / P Lowery Threaded Type Hanger Flange, With 2 7/8" 8 Rd Eue Male Top Thread X 2 7/8" 8 Rd Eue Female Bottom Thread, With R-46 Ring Joint Groove	30102282
7 1/16" 5M PSI W / P Lowery Threaded Type Hanger Flange, With 3 1/2" 8 Rd Eue Male Top Thread X 3 1/2" 8 Rd Eue Female Bottom Thread, With R-46 Ring Joint Groove	30102299
7 1/16" 5M PSI Lowery Threaded Type Hgr Flange, With 2 7/8" 8 Rd Top & Bottom Thread, With Rx-46 Ring Joint Groove, Also W/1/2" NPT Tapped Hole Top & Bottom	30102431
7 1/16" 10M PSI Lowery Threaded Type Hgr Flange, With 2 7/8" 8 Rd Top & Bottom Thread, With Bx-156 Ring Joint Groove	30102422
7 1/16" 10M PSI Lowery Threaded Type Hgr Flange, With 2 7/8" 8 Rd Top & Bottom Thread, With Bx-156 Ring Joint Groove	30102419
7 1/16" 10M PSI Lowery Threaded Type Hgr Flange, With 2 3/8" 8 Rd Top & Bottom Thread, With Bx-156 Ring Joint Groove, Also W/1/2" NPT Tapped Hole Top & Bottom	30102429
7 1/16" 10M PSI Lowery Threaded Type Hgr Flange, With 2 7/8" 8 Rd Top & Bottom Thread, With Bx-156 Ring Joint Groove, Also W/ 1/2" NPT Tapped Hole Top & Bottom	30102428
7 1/16" 15M PSI Lowery Threaded Type Hgr Flange, With 2 7/8" 8 Rd Top & Bottom Thread, With Bx-156 Ring Joint Groove	30102439
7 1/16" 15M PSI Lowery Threaded Type Hgr Flange, With 2 7/8" 8 Rd Top & Bottom Thread, With Bx-156 Ring Joint Groove	30102440

THREADED FLANGES



Drilling Flange/BOP Adapter Flange Features:

- 2M/3M Double drilled
- 5M Available
- One Piece, no weld
- API Flanges available and/or non-API flanges available (1" stand-off)

DESCRIPTION	PART NUMBER	O-RING
7 1/16" 2000- 3000# (6 " 600- 900) X 6 9/16" 6 V Female RTJ Lowery B.O.P. Adapter Flange L-SW	30102270	301107
7 1/16" 2000- 3000# (6 " 600- 900) X 7 5/8" 8R API Mod Female RTJ Lowery B.O.P. Adapter Flange L-K	30102303	30744
7 1/16" 5M X 7 5/8" 8 Rd API Mod Female RTJ Lowery B.O.P. Adapter Flange L-K	30102310	30744
7 1/16" 2000 - 3000# (6" 600-- 900#) X 7" 8 Rd API Female RTJ Lowery B.O.P. Adapter Flange L-HB 4 1/2" & 5 1/2"	30102297	303042
7 1/16" 2000- 3000# 6" 600-900 RTJ X 5 1/2" 8R Lowery B.O.P. Adapter Flange L-S	30102298	30957
7 1/16" 2000--3000# 6" 600--900 X 8 5/8" 8 Rd Female API RTJ Lowery B.O.P. Adapter Flange L-HB 7", L-A7 & L-SO	30102292	303052
7 1/16" 5M X 8 5/8" 8 Rd Female API RTJ Lowery B.O.P. Adapter Flange L-HB 7", L-A7 & L-SO	30102309	303052
7 1/16" 2000 -3000# 6" 600-- 900 X 8 1/4" 6 V Female RTJ Lowery B.O.P. Adapter Flange L-HW	30102253	303052
7 1/16" 2000 -3000# 6" 600--900 X 8 5/8" 8 Rd API Mod Female RTJ Lowery B.O.P. Adapter Flange L-R	30102300	303052
7 1/16" 5M X 8 5/8" 8 Rd API Mod Female RTJ Lowery B.O.P. Adapter Flange L-R	30102301	303052
11" 2000# -3000# (10" 600--900) X 10 3/4" 8 Rd API Modified Female RTJ Lowery B.O.P. Adapter Flange 8 5/8" L-92 With 1/4" Dia. O-Ring	30102259	301500
11" 2000# -3000# (10" 600--900) X 11 3/4" 8 Rd API Modified Female RTJ Lowery B.O.P. Adapter Flange 9 5/8" L-92 With 1/4" Dia. O-Ring	30102275	301726
11" 2000# -3000# (10" 600--900) X 10 3/4" 8 Rd Female API RTJ Lowery B.O.P. Adapter Flange 8 5/8" -10 1/4" L-ECA & 8 5/8" L-CJ With 1/4" Dia. O-Ring	30102276	301500
11" 2000# -3000# (10" 600--900) X 11 3/4" 8 Rd Female API RTJ Lowery B.O.P. Adapter Flange 9 5/8" -11 3/4" L-CJ With 3/16" Dia O-Ring	30102260	301575

SEATING NIPPLES

Seating nipples are a completion component fabricated as a short section of heavy wall tubular with a reduced bore smaller than the Tubing ID. They prevent flow control tools from passing through and are available for single or dual completions.



Part Number: 113009
2.87 x 8 inch
Seating Nipple
2.28" ID



Part Number: 113009
2.87 x 12 inch
Seating Nipple
2.28" ID



Part Number: 113000
2 1/2" x 8"
Seating Nipple
1.78" ID



Part Number: 113001
2 1/2" x 12"
Seating Nipple
1.78" ID

SEATING NIPPLE OPTIONS AND TUBING THREADS

Nominal Pipe Size	THREAD	OD	ID*
2"	API UPSET	2.594	1.780
2 1/2"	UPSET	3.094	2.250
2 1/2"	API UPSET	3.094	2.280
*I.D. +.010			
*I.D. -.000			

SPECIFY LENGTH WHEN ORDERING



Rod Accessories

PUMPING TEES

Ductile Iron construction, 3000 PSI rated, multiple thread combinations, and 1" NPT standard bleeder port available on all models.

Notes:

- Pumping Flow Tee has a 1" NPT minor side outlets for bleeder ports unless specified otherwise. Bleeder can be left blank.
- Last thread in each series is the major side outlet.
- Light weight Tee's available upon request, please consult factory for pricing

WNS Lowery Coating: Call for pricing.



3000# WORKING PRESSURE (INCHES)	PART NUMBER	WEIGHT (LBS)
2 3/8 RD x 2 3/8 RD x 2 11 1/2 V	120601	9
2 3/8 RD x 2 11 1/2 V x 2 11 1/2 V	120602	9
2 11 1/2 V x 2 11 1/2 V x 2 11 1/2 V	120701	9
2 3/8 RD x 2 3/8 RD x 2 11 1/2 V	120801	13
2 3/8 RD x 2 3/8 11 1/2 V x 2 11 1/2 V	120802	13
2 3/8 RD x 2 3/8 8V x 2 11 1/2 V	120803	13
2 3/8 RD x 2 3/8 RD x 2 11 1/2 V	120804	13
2 3/8 RD x 2 3/8 RD x 2 3/8 8V	120805	13
2 3/8 RD x 2 3/8 8V x 2 3/8 8V	120806	13
2 3/8 RD x 2 3/8 RD x 3 8V	120807	20
2 3/8 RD x 2 3/8 11 1/2 V x 3 8V	120808	20
2 3/8 RD x 2 3/8 8V x 3 8V	120809	20
2 3/8 RD x 3 8V x 3 8V	120810	18
2 3/8 RD x 3 8V x 2 11 1/2 V	120811	20
3 8RD x 3 8RD x 3 8V	120901	18
3 8RD x 3 8V x 3 8V	120902	18
3 8RD x 3 8RD x 2 11 1/2 V	120903	20
3 8RD x 2 3/8 RD x 3 8V	120905	20
3 8V x 3 8V x 3 8V	120921	18
3 8V x 3 8V x 2 11 1/2 V	120922	20
2 3/8 RD Male x 2 3/8 RD x 2 11 1/2 V	121001	7
2 3/8 RD Male x 2 11 1/2 V x 2 11 1/2 V	121002	7
2 3/8 RD Male x 2 3/8 RD x 2 11 1/2 V	121101	10
2 3/8 *RD Male x 2 3/8 11 1/2 V x 2 11 1/2 V	121102	10
2 3/8 RD Male x 2 3/8 8V x 2 11 1/2 V	121104	10
2 3/8 RD Male x 3 8V x 2 11 1/2 V	121105	10

ROD LUBRICATOR

The Series PRL polished rod lubricator provides lubrication to polished rods reducing friction heat and rod damage while extending the life of stuffing box and packing rubbers. Its simple, cost effective design mounts on top of the stuffing box with ease due to its clam shell design. The Series PRL features felt wicks (available in various rod sizes) and two tie-down chains.

Application

Mounts on top of stuffing box with ease due to its clamshell design. It also provides lubrication to polished rods thus reducing friction heat.

The WNS Series PRL is a simple, cost-effective solution to reduce damage to polished rods and extend life of stuffing box and packing rubbers.

Features

- Rugged design made of cast aluminum
- Simple installation, mounts to any stuffing box
- Identical box sides, spring/pin can be used on both sides
- Comes with two chain tie downs and hardware
- Utilized industry standard works
- Multiple wick sizes available to fit polished rods

Specification

- One quart capacity
- Dimensions: 5.50 (H); 6.50 (W)
- Wick Sizes: 1-1 3/4"



How to Order

	PRL W/ WICKS	WICKS ONLY
Lubricator PRL Less Wicks	112900	N/A
Lubricator PRL w/ 1 Wicks	112901	160011
Lubricator PRL w/ 1- 1 1/4 Wicks	112902	160012
Lubricator PRL w/ 1-1 1/2 Wicks	112903	160013
Lubricator PRL w/ 1-1 3/4 Wicks	112904	160014
Lubricator PRL w/ 1-1 1/2 Wicks	112905	160015
Lubricator PRL w/ 1- 1 7/16 Wicks	112906	160016
Lubricator PRL w/ 1-1 1/2 Wicks	112907	160017
Lubricator PRL w/ 1-1 3/4 Wicks	112908	160018

405-677-7222
 sales@wnsoilfield.com
 www.wnsoilfield.com

POLISHED ROD CLAMPS

Rod clamps bare the weight of the rod string and act as a connecting device between the polished rod and carrier bar. At WNS Lowery, we offer premium forged clamps in both indentation style (1-, 2- & 3-bolt) and friction style (1- & 2-bolt).

Grade 8 Bolts are used

CAUTION: All models can only be used on piston-steel polished rods. Rod clamps are not capable of gripping the spraymetal section of "hardfaced" or "hardcoated" polished rods. Installation of rod clamps on the spraymetal portion of a hardfaced/hardcoated polished rod may crack the hardcoating.

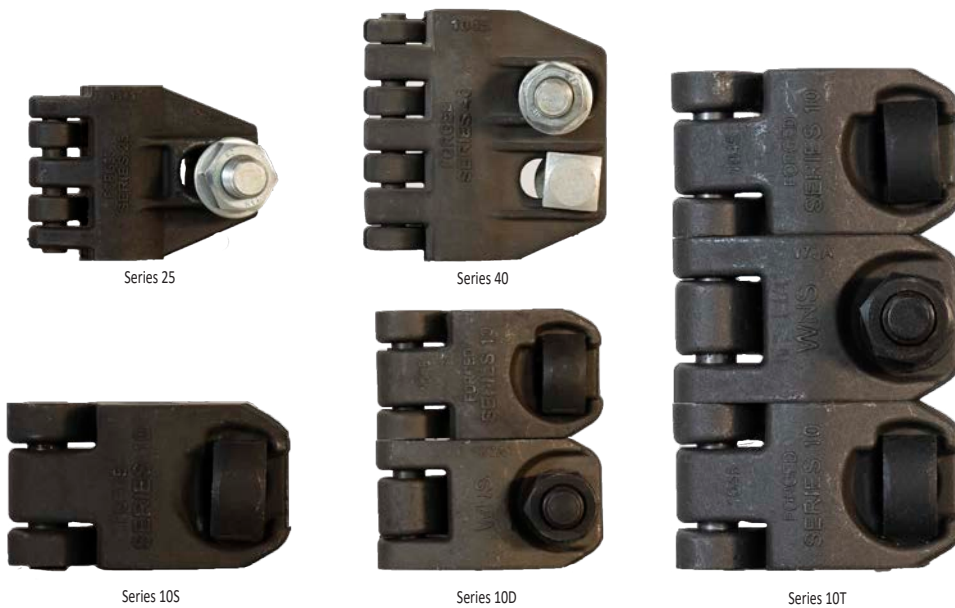

SPECIFICATIONS	SERIES 10S	SERIES 10D	SERIES 10T	SERIES 25	SERIES 40
Rated Load (lbs)	13,000	26,000	40,000	25,000	40,000
Polished Rod Size (Inches)	1, 1 1/8, 1 1/4, 1 3/8, 1 1/2, 1 5/8	1, 1 1/8, 1 1/4, 1 3/8, 1 1/2, 1 5/8	1, 1 1/8, 1 1/4, 1 3/8, 1 1/2, 1 5/8	1, 1 1/8, 1 1/4, 1 3/8, 1 1/2, 1 5/8	1, 1 1/8, 1 1/4, 1 3/8, 1 1/2, 1 5/8
Weight (lbs)	4	8	11	10	24
Height (Inches)	2 1/2	5	7 1/2	4 1/2	6 1/2
Rotating Diameter (Inches)	5 1/4	5 1/4	5 1/4	9	9

ROD ROTATOR

Application

The WNS-302 Rod Rotator is used on pumping units in the oil & gas industry. Its function is to rotate the rod string to effectively reduce rod and tubing wear. This feature can be further enhanced when used in conjunction with rod guides. The WNS-302 Rod Rotator can withstand maximum loads up to 40,000 lbs.

Features

- Rugged industry approved design
- Parts interchange with existing 302 style rotators
- Evenly distribute rod and tubing wear
- Effectively remove paraffin build-up
- Slow gear (SG) option available
- Optional one way bearing
- WNS 302 and WNS 303 SG utilize no-slip bearing replacement ratchet panel design

Specification

- Max Output Torque: 240 ft/lbs
- Max Recommended load: 40,000 lbs
- Required Opening between bridal lines: 7"
- Polished Rod Sizes: 1 1/8 to 1 3/4 inches
- Rotation Type: Helical Gear
- Body Material: Ductile Iron
- 90 Lever Pulls Per Revolution: 77 (std), 154 (SG)
- Shipping Weight: 47 lbs
- Height: 6 1/2"

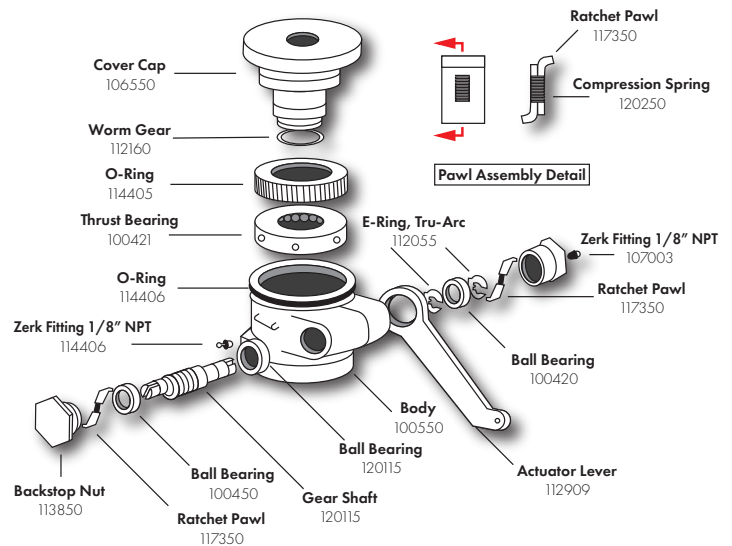

How to Order

MODEL NUMBER	PART NUMBER
WNS-302	119040
WNS-302 SG	119045
WNS-303	119047
WNS-303 SG	119048

405-677-7222
 sales@wnsoilfield.com
 www.wnsoilfield.com

STUFFING BOXES



BIG BOY SINGLE PACKED STUFFING BOX 1,500 PSI WORKING PRESSURE

Connection Size	2 3/4, 2 1/2, 3
Weight (lbs)	20
Height (Inches)	9 3/4
Material	Ductile Iron
Cone Packing Sizes (Inches)	1, 1 1/4, 1 1/2, 1 3/4, 1 1/2, 1 1/4, 1 1/4

Notes: Dome Packing Available



BIG BOY DUAL PACKED STUFFING BOX 1,500 PSI WORKING PRESSURE

Connection Size	2 3/4, 2 1/2, 3
Weight (lbs)	45
Height (Inches)	15
Material	Ductile Iron
Cone Packing Sizes (Inches)	1, 1 1/4, 1 1/2, 1 3/4, 1 1/2, 1 1/4, 1 1/4

Notes: Dome Packing Available



SINGLE PACKED (SB) 1,500 PSI WORKING PRESSURE

Connection Size	2 3/4, 2 1/2, 3
Weight (lbs)	24
Height (Inches)	13 1/2
Material	Ductile Iron
Cone Packing Sizes (Inches)	1, 1 1/4, 1 1/2, 1 3/4, 1 1/2, 1 1/4, 1 1/4

Notes: Inverted Model Available



DOUBLE PACKED (SB) 1,500 PSI WORKING PRESSURE

Connection Size	2 3/4, 2 1/2, 3
Weight (lbs)	45
Height (Inches)	14
Material	Ductile Iron
Cone Packing Sizes (Inches)	1, 1 1/4, 1 1/2, 1 3/4, 1 1/2, 1 1/4, 1 1/4

Notes: Inverted Model Available



TEE BASE STUFFING BOX 1,500 PSI WORKING PRESSURE

Connection Size	2 3/4, 2 1/2, 3
Weight (lbs)	30
Height (Inches)	12
Material	Ductile Iron
Cone Packing Sizes (Inches)	1, 1 1/4, 1 1/2, 1 3/4, 1 1/2, 1 1/4, 1 1/4

Notes: Inverted Model Available



MINI PACK STUFFING BOX 1,500 PSI WORKING PRESSURE

Connection Size	2" 11.5V
Weight (lbs)	10
Height (Inches)	7
Material	Carbon Steel
Crown Ring Packing Sizes (Inches)	1 1/4, 1 1/4

STUFFING BOXES



Oil Reservoir Gland

Accessories

LUBRICATING UPPER GLAND*

	Part Number	Weight (lbs)
Complete	112507	9
Parts		
Body	112302	5
Cone Pkg Ring(1)	115607	¼
Gland Cap	106302	3
Gland Cap Bolts (2/set)	101301	1

*Specify Polished Rod Size

OIL RESERVOIR GLAND

	Part Number	Weight (lbs)
Complete	112707	23
Parts		
Body w/ Plugs	101203	5
Cone Pkg Ring(1)	115507	¼
Drain Nipple	113401	½
Gland Cap	106402	7
Gland Cap Bolts (2/set)	102201	¼

*Specify Polished Rod Size

DOUBLE PACKED (DPSB) 1,500 PSI WP POLISHED ROD SIZES 1-1 ¼

Tubing Size (Male Thread in Inches)	Weight (lbs)
2	50
2 ½	51
3	52

Stuffing Box Leak Detector

The stuffing box leak detector is made using corrosion resistant parts. The split adapter allows easy installation on the wellhead, and it is strong enough to take the weight of the rod string. The standard adapter will fit most stuffing boxes in use in the USA, and custom adapters can be special ordered to fit other stuffing box designs. The adapter is compact to minimize clearance or misalignment problems. The primary objective of the leak detector is the prevention of pollution resulting from leakage of fluids past the sealing members of stuffing boxes on rod pumped wells. The adapter provides a minor increase in the amount of lubricating oil for the seals, or it can be equipped with a crown ring to control the grease on those wellheads where grease is used for lubrication. The clear plastic reservoir removes easily for emptying, cleaning, or testing of the electrical circuitry. The reservoir is economical to replace if damaged.

Features:

- Clear Fluid and Stainless Steel Reservoir available
- Corrosion Resistant Components
- Long Travel Float Switch
- Both Normally Open and Closed contacts
- Class 1 Div. 1 Explosion Proof Switch



STUFFING BOX LEAK DETECTOR	PLASTIC PART NUMBER	STAINLESS STEEL PART NUMBER
Complete	112007	112017
Oil Reservoir Gland	112707	N/A
Control Device	112051	112053

405-677-7222
sales@wnsoilfield.com
www.wnsoilfield.com

CONE PACKING

The most important part in a stuffing box is its cone packing. Cone packing is the seal between production fluid and polished rods. WNS Lowery offers a variety of sizes and materials to meet the rigorous demands of the oil and gas industry.

Our cones have a larger working area as the rod passes through the sealing area, making it last longer. The cone packing also has an oil reservoir for the oil at the top. This serves as a lubrication factor as the polish rod passes through. Cone packing is available in all polished rod sizes: 1" through 1 3/4" in sets of 4 (3 top cones & 1 bottom cone).

The guidelines on this page are for general purposes only and should not be used as the sole determining factor for packing material selection. Each down hole condition is different and must be addressed on a case-by-case basis to determine the best material solution for your particular well condition.



CONE PACKING

Soft	For normal pumping wells. Standard packing in all WNS Lowery stuffing boxes for any type polished rod or liner.
Hard	For wells that produce large volumes of water. Use only on hard-faced liner
Special Lubricated	Self-contained lubricant for wells with an absence of fluid.
Heavy Duty	For wells that pump off or flow off.
High Temp	For high-temperature applications to 425°F max.
Teflon Filled	Longer-lasting for pumping situations such as long stroke, fast cycle, or lack of lubrication.
Brass Teflon	Combines the longevity of Teflon with the cleaning action of brass. Used on steel polished rods, or hard-faced liners only.
Type WN-G	For wells with H ₂ S or in CO ₂ service.
Bottom Cleaner Cones	Helps prevent undesirable deposits on polished rods or liners.

BLOW OUT PREVENTERS

Blow-out preventers are used for well control and monitoring. Utilizing the included handles and ram sets, operators can seal the tubing annulus for well servicing. Our blow-out preventer is offered with Ductile Iron caps that are ACME threaded. This thread type provides easy removal and reduces the possibility of cross threading. Provided ram sets are metal reinforced for better stability and longer life. WNS Lowery offers a growing line of BOP's, ranging from several working pressures models.

Features

- Full opening bore 2- 2 ½ (2.000-2.562) 3" 8V
- O-Ring on cap ensures no leakage
- Ductile Iron Body & Cap (Heavy Acme Threads)
- Metal reinforced ram block.
- 1500 PSI working pressure
- Zinc plated ram screw & locking nut-reduces corrosion
- Nylon Packing seal can be replaced in the field
- Traceable per API Specifications

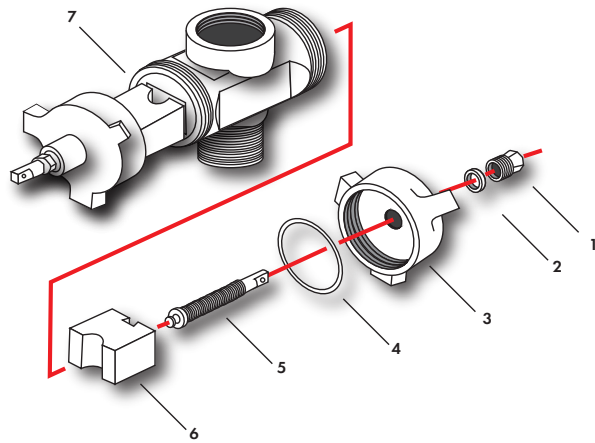

Specifications	Weight (lbs)	Standard Item Number	High Temp. Item Number
Complete Assembly 2, 2 ½, 3 L.P.	43	*	*
1 Pkg Gland	¼	112711	112711
2 Pkg. Ring (One)	0	119053	119053
3 Wing Cap	6	106615	106605
4 O-Ring	-	114351	114352
5 Ram Screw	1	119451	119451
6 Rams, Blind (Set)	3	118636	118646
6 Rams, ¾-1 Rods (Set)	3	118631	118641
6 Rams, 1 ¼ Rods (Set)	3	118632	118342
6 Rams, 1 ½ Rods (Set)	3	118633	118643
6 Rams, 1 ¾ Rods (Set)	3	118634	118644
6 Rams, 2 ¼ Rods (Set)	3	118635	118645
7 Body 2, 2 ½, 3 (Specify)	26 ½	*	*
Flip Over Handles (Set)	4	112746	112746

Specifications	
Working Pressure	1,500 PSI
Ram Sizes(Inches)	1 ¼, 1 ½, 1 ¾, 2 - 1", Blind
Ram Rubber	70 Duro Buna STD. HSN Available
Ram screw & lock nut	Carbon Zinc Plated
Connections	Male & Female
Cap Thread	5 Inch Diameter 4 Acme
Body Material	Ductile Iron
Height (Inches)	9 ½
Weight (lbs)	46
Handles	Ductile Iron

405-677-7222
 sales@wnsoilfield.com
 www.wnsoilfield.com

A tall, lattice-structured oilfield derrick stands in a green field under a blue sky. The derrick has a red platform at the top and a white box on its side. A white banner with the word "Valves" is overlaid on the image.

Valves

SERIES 20 CHOKE

This choke allows producers to “choke” back well pressure so the well can be set at its optimum production level. The WNS Lowery Series 20 is offered with a forged steel body, hardened alloy trim and reversible seat.

2" 2000# CWP FNPT Inlet with MNPT outlet; forged steel body, hardened alloy trim, 3/4, or 1 orifice; reversible seat.

2" 3000# CWP FNPT Inlet with MNPT outlet; forged steel body, hardened alloy trim, 3/4, or 1 orifice; reversible seat



PARTS

Item	Part #	Description
1	101300	Handle bolt 3/8 - N.C. Cap Screw
2	160001	Handle washer 3/8 flat washer
3	112748	Handle (Oval hole)
4	119460	Set screw F/ calibration sleeve 1/4- N.C.
5	112760	Indicator (Specify oriface size)
6	120310	Stem
7	119806	Seal kit
8	119461	1/4 - N.C. set screw
9	120120	Calibration sleeve (specify oriface size)
10	090505	Bonnet
11	170002	Grease zerk 1/8 -NPT
12	119465	Thumb screw 1/4-N.C.
13	120411	2000# Tee
14	120511	3000# Tee
15	120105	Seat, Reversible (specify oriface size)

405-677-7222
 sales@wnsoilfield.com
 www.wnsoilfield.com

SWING CHECK VALVES

WNS Lowery Series Domestic and Import swing check valves offer excellent flow back protection on production lines in all types of oil, gas, and industrial applications. Maintenance is quick and easy with the valves top entry design and available repair kits. Our import line is in stock and ready for immediate shipment at a value price. Our domestic line is handcrafted from castings made in the USA and is assembled and tested by American workers.

Threaded Bonnet

- Ductile Iron or Cast Steel
- NACE materials per MR0175 are standard on all valves



SWING CHECK VALVES			
Part	Material Specifications		
Body & Bonnet	ASTM A-536 Ductile Iron	ASTM A-216 WCB Cast Carbon Steel	Service Temperature
Clapper	316 SS STD	316 SS STD	
Clapper Seal	Buna-N (Standard) Viton (Optional) HNBR (Optional)	Buna-N (Standard) Viton (Optional) HNBR (Optional)	180°F Max 400°F Max 300°F Max
Bonnet Seal O-Ring	Buna-N (Standard) Viton (Optional) HNBR (Optional)	Buna-N (Standard) Viton (Optional) HNBR (Optional)	180°F Max 400°F Max 300°F Max

SWING CHECK REPAIR PARTS				
Description	1 Item Number	2 Item Number	3 Item Number	4 Item Number
Bonnet Cap				
Ductile Iron	102301	102401	102501	102601
WCB Steel	102301	102402	102502	N/A
Bonnet Pipe Plug	N/A	117501	117501	117501
Bonnett O-Ring				
Buna-N	114001	114101	114201	114301
Viton	114002	114102	114202	114302
HSN	114004	114104	114204	114304
Clapper Seal				
Buna-N	119501	119601	119701	119801
Viton	119502	119602	119702	119802
HSN	119504	119604	119704	119804
Clapper Assy				
316SS/Buna-N	108401	108501	108604	108701
316SS/Viton	108402	108502	108605	108702

SWING CHECK VALVES

- WCB Steel
- Threaded Swing Check Valve

Options:

- Viton Trim
- WNS-Coat

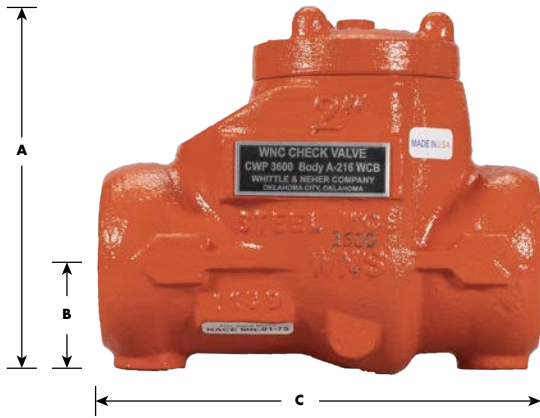

2" Swing Check Valve

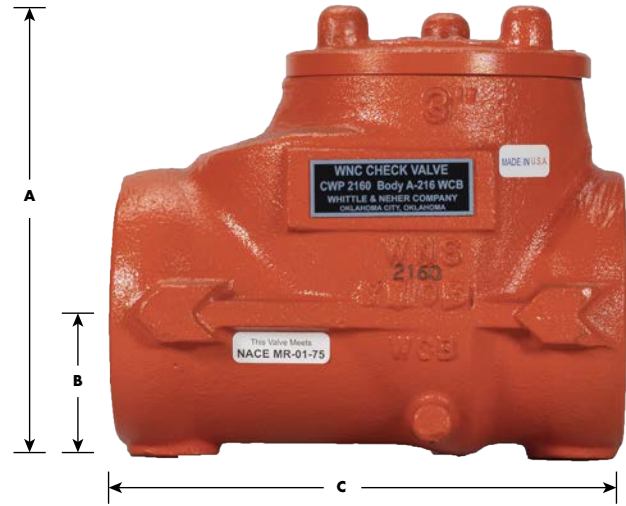

3" Swing Check Valve

WCB STEEL THREADED ENDS SWING CHECK VALVE

Valve Size	End to End (Inches)	Working Pressure	Weights (lbs)	Item Number	Model Number
1	4 ¼	275	6	124801	WN1-275
		720		124802	WN1-720
		1440		124803	WN1-1440
		2160		124804	WN1-2160
		3600		124805	WN1-3600
		5000		124806	WN1-5000
2	7 ¼	275	16	125801	WN2-275
		720		125802	WN2-720
		1440		125803	WN2-1440
		2160		125804	WN2-2160
		3600		125805	WN2-3600
3	8	275	17	128101	WN3-275
		720		128102	WN3-720
		1440		128103	WN3-1440
		2160		128104	WN3-2160

CAST STEEL THREADED END

Size (Inches)	Pressure (PSI)	Weight (lbs)	Dimensions (Inches)		
			A	B	C
1	275	6	3	1 ¼	4 ¼
2	275	16	3 ¾	1 ¼	7 ¼
3	275	17	5 ½	2 ¾	8
1	720	6	3	1 ¼	4 ¼
2	720	16	3 ¾	1 ¼	7 ¼
3	720	17	5 ½	2 ¾	8
1	1440	6	3	1 ¼	4 ¼
2	1440	16	3 ¾	1 ¼	7 ¼
3	1440	17	5 ½	2 ¾	8
1	2160	6	3	1 ¼	4 ¼
2	2160	16	3 ¾	1 ¼	7 ¼
3	2160	17	5 ½	2 ¾	8
1	3600	6	3	1 ¼	4 ¼
2	3600	16	3 ¾	1 ¼	7 ¼
1	5000	6	3	1 ¼	4 ¼

405-677-7222

sales@wnsoilfield.com

www.wnsoilfield.com

SWING CHECK VALVES

- Ductile iron
- Threaded swing check valve
- Grooved swing check valve

Options:

- Viton Trim
- WNS-Coat

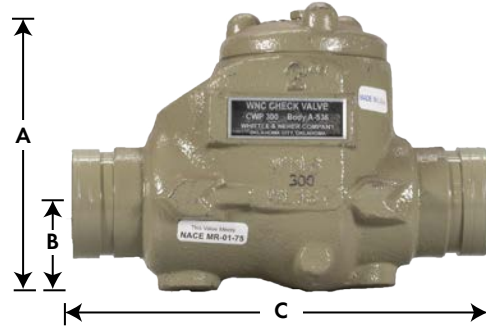
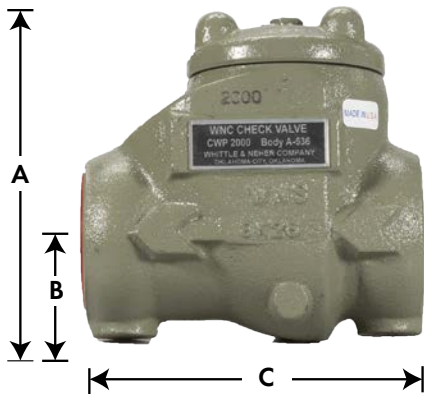

DUCTILE IRON THREADED END

Size (Inches)	Pressure (PSI)	Weight (lbs)	Dimensions (Inches)		
			A	B	C
2	300	11	3 3/4	1 1/4	6
2 LP	300	15	3 3/4	1 1/4	7 1/4
3	300	17	5 1/2	2 3/4	8
4	300	35	6 3/4	3	10
2	600	11	3 3/4	1 1/4	6
2 LP	600	15	3 3/4	1 1/4	7 1/4
3	600	17	5 1/2	2 3/4	8
4	600	35	6 3/4	3	10
1	1000	4 1/2	3	1 1/4	4 1/4
2	1000	11	3 3/4	1 1/4	6
2 LP	1000	15	3 3/4	1 1/4	7 1/4
3	1000	17	5 1/2	2 3/4	8
4	1000	35	6 3/4	3	10
1	1500	4 1/2	3	1 1/4	4 1/4
2	1500	11	3 3/4	1 1/4	6
2 LP	1500	15	3 3/4	1 1/4	7 1/4
3	1500	17	5 1/2	2 3/4	8
1	2000	4 1/2	3	1 1/4	4 1/4
2	2000	11	3 3/4	1 1/4	6
2 LP	2000	15	3 3/4	1 1/4	7 1/4
3	2000	17	5 1/2	2 3/4	8

DUCTILE IRON THEADED ENDS SWING CHECK VALVE

Valve Size (Inches)	End to End (Inches)	Working Pressure	Weights (lbs)	Item Number	Model Number
1	4 1/4	300	5	124701	WN1-3313
		1000		124703	WN1-11033
		1500		124704	WN1-11533
		2000		124705	WN1-12033
2	6	300	11	125701	WN2-23313
		600		125702	WN2-23613
		1000		125703	WN2-21033
		1500		125704	WN2-21533
2 Long Pattern	7 1/4	2000	15	125705	WN2-22033
		300		126501	WN2-23313-LP
		600		126502	WN2-23613-LP
		1000		126503	WN2-21033-LP
3	8	1500	17	126504	WN2-21533-LP
		2000		126505	WN2-22033-LP
		300		128001	WN3-33313
		600		128002	WN3-33613
4	10	1000	35	128003	WN3-31033
		1500		128004	WN3-31533
		2000		128005	WN3-3203
		300		128901	WN4-43313
600	128902	128903	128903	WN4-43613	
				WN4-41033	

DUCTILE IRON GROOVED ENDS SWING CHECK VALVE

Valve Size (Inches)	End to End (Inches)	Working Pressure	Weight (lbs)	Item Number	Model Number
2 Long Pattern	9	300#	11	130001	WN2-23313-LP-G
		600#		130002	WN2-23613-LP-G
3	10 1/4	300#	16	130601	WN3-33313-G
		600#		130602	WN3-33613-G

IMPORT SWING CHECK VALVE

Application:

The WNS Series iWVS swing check valve offers oil & gas producers excellent back flow protection on production lines in all types of service including salt water or other corrosive applications.

Maintenance is quick and simple with the valves top entry design and available repair kits. Contact your local WNS representative to learn more about our economical line of Swing Check Valves.

Features:

- Top entry for simple, quick repair or internal inspection
- 316 SS Flapper
- Materials meet NACE MR0-175
- Viton Seals
- 2" available in long pattern
- 4" Ductile Heavy-Duty valve available up to 2000 psi

Specifications:

- Ductile iron or carbon steel
- 1" - 4" FNPT end connections
- -20 F to +400 F temperature range
- 300 to 5000 working pressure range

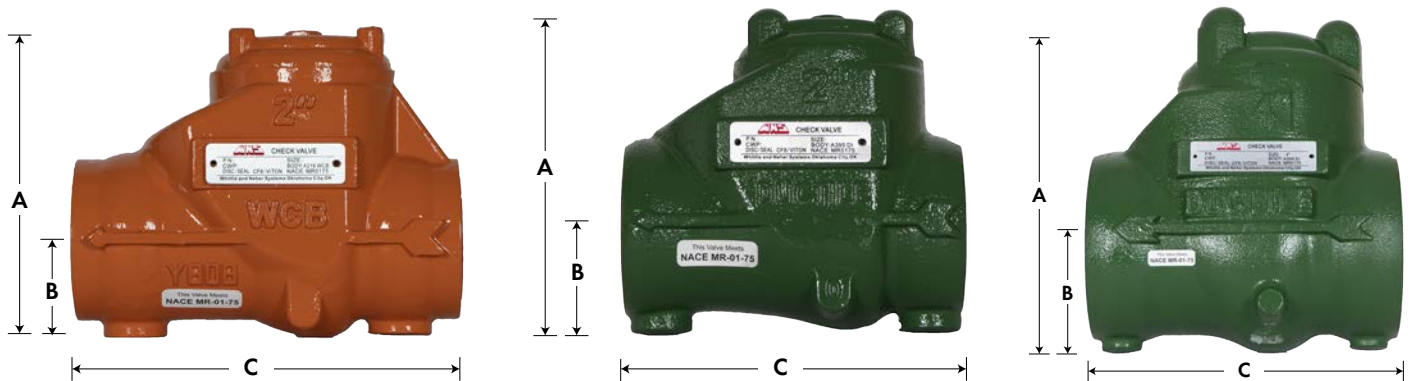

Parts and Materials			
Number	Description	DI	CS
1	Body	ASTM A395 DI	ASTM A216 WCB
2	Disc/Flapper	ASTM A351 (CF8) SS	ASTM A351 (CF8) SS
3	Flapper Seal	Viton	Viton
4	Bonnet	ASTM A395-DI	ASTM A216 WCB
5	Bonnet O-ring	Viton	Viton
6	Bonnet Screw	Carbon Steel	Carbon Steel

Dimensions (Inches)						
Size (Inches)	Ductile Part #	Carbon Part #	A	B	C	Weight (lbs)
1	iWVS1D_	iWVS1C_	3.23	1	4.72	6.0
2	iWVS2D_	iWVS2C_	4.09	2	6.30	12.0
2LP	iWVS2D_L	iWVS2C_L	4.09	2	7.25	16.0
3	iWVS3D_	iWVS2C_	5.00	3	8.25	23.0
4	iWVS4D_	NA	6.00	4	10.00	36.0
4**	iWVS4D_H	NA	8.00	4	10.00	58.0

405-677-7222
 sales@wnsoilfield.com
 www.wnsoilfield.com

BALL CHECK VALVES

WNS Lowery Series Domestic and Import ball check valves offer excellent flow back protection on production lines in all types of oil, gas, and industrial applications. Our valves can be mounted horizontally or vertically (flow up). Our domestic line is truly handcrafted from castings made in the USA and assembled and tested by American workers.

Features:

- Replaceable resilient seal with secondary metal-to-metal seal
- Nominal flow restriction
- Can be installed Horizontal or Vertical
- No ball spring
- Minimum parts wear from low flow rates or pulsating service
- End entry ball check valve
- Ductile Iron
- WCB Steel
- 316 SS Steel

Options:

Viton Trim
WNS-Coat

Trim:

- Seal - Buna-N 180°F Max (Standard)
- Viton 400°F Max (Optional)



DUCTILE IRON THREADED END ENTRY BALL CHECK VALVE

Valve Size (Inches)	End to End (Inches)	Working Pressure (PSI)	Weight (lbs)	Item Number	Model Number
½	3 ¾	1000	1	122253	WN5-B1033
		1500		122254	WN5-B1533
		2000		122255	WN5-B2033
1	4 ½	1000	4	122303	WN1-B1033
		1500		122304	WN1-B1533
		2000		122305	WN1-B2033
2	6	1000	13	123203	WN2-B1033
		1500		123204	WN2-B1533
		2000		123205	WN2-B2033

WCB STEEL THREADED END ENTRY BALL CHECK VALVE

Valve Size (Inches)	End to End (Inches)	Working Pressure (PSI)	Weight (lbs)	Item Number	Model Number
1	4 ½	2000	4	122401	WN1-B2033-CS
		3000		122402	WN1-B3033-CS
		5000		122403	WN1-B5033-CS
2	6	2000	13	123301	WN2-B2033-CS
		3000		123302	WN2-B3033-CS
		5000		123303	WN2-B5033-CS

BALL CHECK REPAIR PARTS

Description	Valve Size (Inches)	Ball Size (Inches)	Item Number
440 SS Ball	½	¾	100100
	1	1 ½	100101
	2	1 ¾	100102
SS/Buna-N Seat	½	N/A	119901
	1	N/A	120001
	2	N/A	120101
SS/Viton Seat	½	N/A	119911
	1	N/A	120002
	2	N/A	102102

316 SS STEEL THREADED END ENTRY BALL CHECK VALVE

Valve Size (Inches)	End to End (Inches)	Working Pressure (PSI)	Weight (lbs)	Item Number	Model Number
1	4 ½	2000	4	122501	WN1-B2033-SS
		3000		122502	WN1-B3033-SS
		5000		122503	WN1-B5033-SS
2	6	2000	13	123401	WN2-B2033-SS
		3000		123402	WN2-B3033-SS
		5000		123403	WN2-B5033-SS



IMPORT BALL CHECK VALVE

APPLICATION

The Series iWVB ball check valve offers oil & gas produces excellent back flow protection on production lines in all types of service including salt water or other corrosive applications.

The Series iWVB can be mounted horizontally or vertically (up flow). Contact your local WNS Lowery representative to learn more about our economical line of Ball Check Valves.

FEATURES

- Replaceable resilient seal
- Nominal flow restriction
- 316 SS Ball
- Viton Seats
- Threaded Ends conform to ANSI B1.20.1 (NPT)
- Materials meets NACE MR0175
- Gravity return eliminates need for ball return spring

SPECIFICATIONS

- Ductile Iron/Carbon Steel/Stainless Steel body
- 1-2 FNPT end connections
- -20°F - +400°F Temperature rating
- 2000-5000 Max working pressure range



No.	Description	DI	CS	SS
1	Body	ASTM A395	ASTM A216 WCB	ASTM A351 CF8M
2	Adapter	ASTM A395	ASTM A216 WCB	ASTM A351 CF8M
3	Ball	316SS	316SS	316SS
4	Seat	Viton	Viton	Viton

Dimensions (Inches)							
Material	Size	Part #	Connection	Pressure (PSI)	Weight (lbs)	L (Inches)	H (Inches)
Ductile Iron	1	iWVB1D20	FNPT	2000	3.75	4.49	2.06
	2	iWVB2D20	FNPT	2000	11.91	6.62	3.37
Carbon Steel	1	iWVB1C20	FNPT	2000	4.86	4.49	2.06
	1	iWVB1C30	FNPT	3000	4.86	4.49	2.06
	1	iWVB1C50	FNPT	5000	4.86	4.49	2.06
	2	iWVB2C20	FNPT	2000	12.46	6.62	3.37
	2	iWVB2C30	FNPT	3000	12.46	6.62	3.37
	2	iWVB2C50	FNPT	5000	12.46	6.62	3.37
Stainless Steel	1	iWVB1S20	FNPT	2000	3.97	4.49	2.06
	1	iWVB1S30	FNPT	3000	3.97	4.49	2.06
	1	iWVB1S50	FNPT	5000	3.97	4.49	2.06
	2	iWVB2S20	FNPT	2000	12.57	6.62	3.37
	2	iWVB2S30	FNPT	3000	12.57	6.62	3.37
	2	iWVB2S50	FNPT	5000	12.57	6.62	3.37

405-677-7222
 sales@wnsoilfield.com
 www.wnsoilfield.com

BACK PRESSURE REGULATOR

The WNS Lowery 7702 BPR offers automatic relief of pressure in liquid or gas services. This valve can be used for a variety of applications including paraffin reduction by keeping gas in solution, pump efficiency by keeping bottom-hole pressure above bubble point or as a bypass to casing in the event a lead line freezes or plug.

- Liquid or gas service
- Reduces paraffin by keeping gas in solution
- Less free gas and better lubrication at stuffing box
- Increases pump efficiency by keeping bottom hole pressure above bubble point
- Differential pressure type-recommended for systems where down-stream pressure is less that 10% of set pressure
- 2" Regulator has standard ¼" NPT pressure port for proper gauge orientation
- Standard connections: 2" male LP inlet x single 2" female LP outlet
- Optional connections: 2" male LP inlet x two 2" female LP outlets using 4-way cross
- External body shell components for all assemblies have a 2000 PSI "Shell Test Pressure" capability

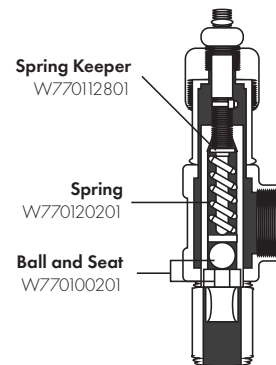
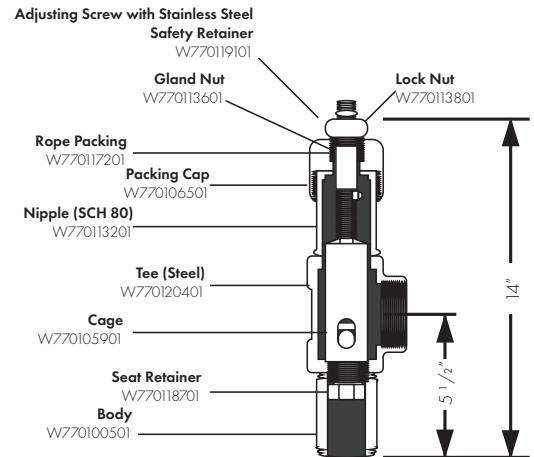

2" VALVE COMPLETE	
Item Number	Range (PSI)
W7702TS020CS	10-200
W7702TS050CS	10-500
W7702TS090CS	10-900
W7702TS015CS	10-1500

Parts List	
Part Name	Item Number
Body	W770100501
Cage	W770105901
Seat Retainer	W770118701
Spring 10-200 PSI	W770120201
Spring 10-500 PSI	W770120202
Spring 10-900/ 1500 PSI	W770120203
Spring Keeper	W770112801
Lock Nut	W770113801
Adjusting Screw	W770119101
Packing Cap	W770106501
Gland Nut	W770113601
Rope Packing	W770117201
Tee (Steel)	W770120401
Plug ¼ F.S.	W770117501
Nipple (SCH 80)	W770113201
Ball & Seat	W770100201
Ball & Seat 1500#	W770100202

BALANCED BACK PRESSURE REGULATOR

The WNS Lowery Series 772 offers automatic relief of pressure in liquid or gas services. Unaffected by downstream pressures, the balanced design regulates based on upstream pressure.

FEATURES

- Reduces paraffin by keeping gas in solution
- SS internals for increased life
- Easy access to the internals for repair or maintenance
- Field adjustability
- Multiple seal options for a wide variety of applications

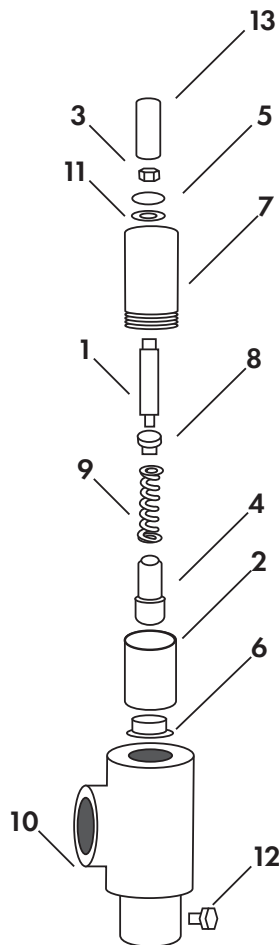
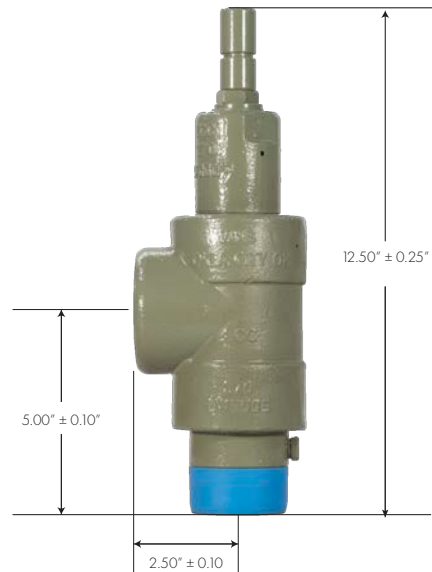

Parts List			
Item	Qty	Description	Item Number
1	1	Adjusting Screw	119102
2	1	Cage	105903
3	1	Nut	113452
4	1	Piston	117403
5	1	Washer, Rubber	160003
6	1	Seat	118702
7	1	Bonnet	102292
8	1	Spring Keeper	112803
9	1	Spring, 30-100 Green	120206
	1	Spring, 30-100 Yellow	120207
	1	Spring, 30-500 Brown	120208
	1	Spring, 30-100 Orange	120209
	1	Spring, 30-100 Black	120210
10	1	Body	100502
11	1	Washer, Steel	160002
12	1	Hex Plug	117501
13	1	Cap	106082
14	1	O-ring, 2-224*	114321
15	1	O-ring, 2-222*	114322
16	1	O-ring, 2-220*	114323
17	1	RING-BACKUP PTFE*	118900
18	1	O-ring, 2-208*	114324
19	2	O-ring, 2-114*	114325

* Not Illustrated

Recommended Replacement Parts			
Item	Qty	Description	Part Number
4	1	Plug	117403
6	1	Seat	118702
14	1	O-Ring, 2-224	Buna 114321
15	1	O-Ring, 2-222	Buna 114322
16	1	O-Ring, 2-220	Buna 114323
17	1	O-Ring, 2-208	Buna 114324
18	2	O-Ring, 2-114	Buna 114325
19	1	Back Up Ring	118900

Materials of Construction	
Body	LCC Steel
Bonnet	LCC Steel
Cage	17-4PH H900 SS
Body Plug	Xylan Coated CS
Seat	440C SS
Piston	17-4A/H900 SS
Seals	Buna-N
	Viton
	PC Buna
	EPDM
	HSN
Back Up Ring	Teflon
Spring	17-7PH SS
	302SS

405-677-7222
 sales@wnsoilfield.com
 www.wnsoilfield.com

Z-PEX COATING

The common and most pressing cost to modern production systems is the loss of equipment and metal goods to corrosion. The handling of hotter fluids combined with dissolved gases have accelerated lifting costs dramatically. The exposure of inorganic and organic acids, and materials have produced a costly figure in equipment replacement, labor costs, and production down time.

WNS Lowery offers the Z-PEX bonding system to withstand the new production techniques produced by enhanced recovery, stimulation chemistry, and specialty chemical products. Our flexible Z-PEX system has a high heat resistance of 550°F and is resistant to all of the chemicals displayed in the list below. Z-PEX can be applied to the interior, exterior, and threads of all WNS Lowery valves, stuffing boxes, and pumping tees.

Our sales representatives are ready to assist you to ensure the best corrosion protection available in today's price conscious market. Z-PEX offers an effective alternative to expensive special alloy steel or just living with a problem presumed unsolvable.

To ensure the best protection for a given corrosive environment, and to provide maximum service life for your equipment we evaluate the following service conditions:

- Type of fluid, gas, or process stream
- Temperature
- Pressure
- Corrosive agents present

Coating Properties

Dry Film Thickness: 2.0-2.8 mils
Max Operating Temperature: 550°F
Pencil Hardness: 6H
Coefficient of Friction: -0.016 to 0.08
Tabor Abrasion (1000) cycles 7.3 mg lost
Tensile Strength: 3,000 to 4,000 PSI
Salt Spray (ASTM B.117) 4000 Hours Minimum
H₂O (10,000 PSI, 200°F) No effect at any angle
Abrasion Resistance (D4060): 16,200 Units
Direct Impact: 100 lbs
Indirect Impact: 120 lbs
Gloss: 45-55
Color: Dark-Gray
Cross-Hatch Adhesion: 5B
Gravelometer: 6 Minimum

Z-PEX is resistant to the following chemicals

Acetone	Calcium Chloride
Acetic Acid	Calcium Hypochlorite
Acetates (All)	Carbon Tetrachloride
Amines (All)	Cetyl Alcohol
Ammonia	Chlorides (All)
Ammonium Hydroxide	Chlorine Gas
Amino Acids	Chromic Acid (Nr)
Benzene	Citric Acid
Borax	Creosol
Boric Acid	Diesel Fuel
Butyl Alcohol	Diethanolamine
Butyl Cellosolve	Ethyl Acetate
Butyric Acid	Ethyl Alcohol

GENERAL INFORMATION

PRICES:

All prices shown are suggested resale domestic prices and are subject to change without notice. Export crating, freight, insurance, exchange rates, tariffs, or any taxes are the responsibility of the purchaser. All accounts are payable in United States funds.

DISCREPANCIES:

Quantity count discrepancies or errors are to be reported within ten (10) days after the receipt of shipment and must specify invoice number and date of shipment.

CANCELLATION:

All orders received for special products or parts thereof are subject to cancellation only upon agreement to make payment for any material and work performed and a reasonable profit.

WARRANTY:

This Limited Warranty of WNS Lowery, A MARSH BELLOFRAM Company applies to products manufactured or distributed by WNS Lowery, A MARSH BELLOFRAM COMPANY (WNS Lowery). The term "product" means a WNS Lowery device or system, it's features, conversion, upgrades, elements, or accessories, or any combination of them. The product purchased shall be free from defects in material and workmanship from the date of shipment by WNS Lowery, A MARSH BELLOFRAM COMPANY (USA) for one year from the date of shipment from WNS Lowery or authorized reseller.

TERMS OF THE WARRANTY:

WNS Lowery warrants that the product you have purchased from WNS Lowery or a WNS Lowery authorized reseller is free from defects in materials and workmanship under normal use during the warranty period. The warranty period begins on the day of shipment from WNS Lowery. The warranty extends only to the original purchaser. It is not transferable to anyone who subsequently purchases the product from you. It excludes all expendable parts.

During the warranty period, WNS Lowery will repair or replace defective parts with new parts or, at the option of WNS Lowery, serviceable used parts that are equivalent or superior to new parts in performance.

This Limited Warranty extends only to products purchased from WNS Lowery or a WNS Lowery authorized reseller. This Limited Warranty does not extend to any product that has been damaged or rendered defective (a) as a result of accident, misuse, or abuse; (b) as a result of an act of God; (c) by operation outside the usage parameters stated herein; (d) by the use of parts not manufactured or sold by WNS Lowery; (e) by modification of the product; or (f) as a result of service by anyone other than WNS Lowery or a WNS Lowery authorized reseller or authorized agent.

EXCEPT AS EXPRESSLY SET FORTH IN THIS WARRANTY, WNS LOWERY MAKES NO OTHER WARRANTIES EXPRESSED OR IMPLIED, INCLUDING ANY IMPLIED WARRANTIES OR MERCHANTABILITY AND FITNESS FOR A PARTICULAR PURPOSE. WNS LOWERY EXPRESSLY DISCLAIMS ALL WARRANTIES NOT STATED IN THIS LIMITED WARRANTY. ANY IMPLIED WARRANTIES THAT MAY BE IMPOSED BY LAW ARE LIMITED TO THE TERMS OF THIS EXPRESS LIMITED WARRANTY.

RETURNS:

Materials may be returned only with prior written permission of seller, only new (unused) standard catalog items may be returned and for merchandise credit only. Items authorized for return will be subject to a minimum restocking charge of 10% with additional charges being made for items not received in saleable condition. No credit will be allowed for rubber products unless returned within one (1) year of date of shipment from seller's factory. Material must be returned freight prepaid. Outbound transportation charges assumed by the seller will be deducted from the merchandise credit.

Marsh Bellofram: Our Story

Headquartered in Newell, West Virginia, USA, The Bellofram Group of Companies is an AS9100D and ISO9001:2015 certified leading global manufacturer of high-performance OEM, industrial, and process control instrumentation. This includes timers and counters, digital controllers and panel meters, RTD's and thermocouples, pressure instruments and gauges, FRLs, cylinders, natural gas and propane pressure regulators, air pressure regulators and transducers, tank and liquid level measurement systems, pump and motor protection switches, alternating relays, sensors, DC tachometers, encoders, industrial diaphragms, and specialty silicones.

Products are organized and sold under fully dedicated divisions, each staffed with an experienced and highly trained team of dedicated technical sales, applications engineering, and customer service support personnel.





www.wnsoilfield.com
405-677-7222